



RHINO-RACK

RSP27 Rhino Sportz Two Crossbar System Jeep Grand Cherokee

Important:

Please read these instructions prior to installation.
Check contents of kit before commencing fitment and report any discrepancies.
Place these instructions in vehicle's glovebox after installation is complete.

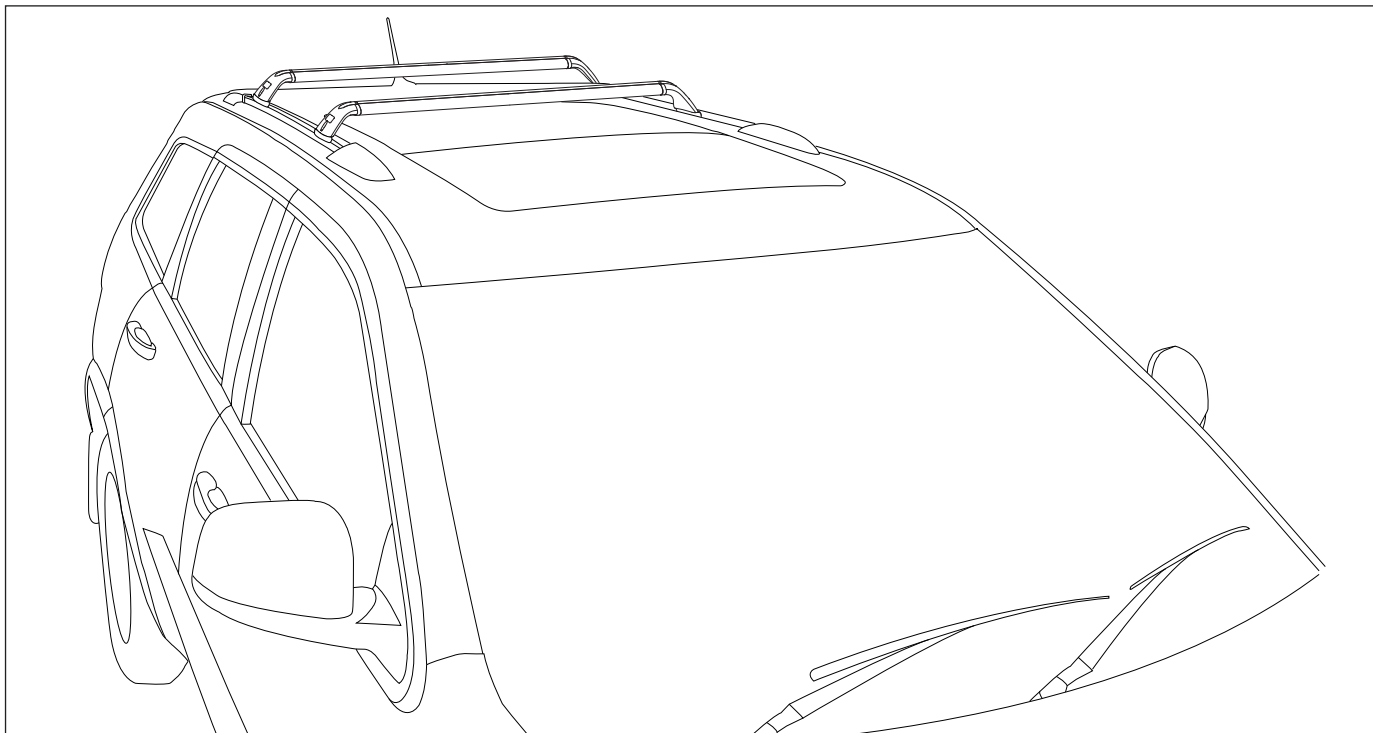

Maximum roof load: 68kg

Refer to vehicle manufacturers handbook for maximum roof loading. Always use lower of the two figures.

Recommendations:

It is essential that all bolt connections be checked after driving a short distance when you first install your crossbars. Bolt connections should be checked again at regular intervals (probably once a week is enough, depending on road conditions, usage, loads and distances travelled). You should also check the crossbars each time they are refitted. Make sure to fasten your load securely. Please ensure that all loads are evenly distributed and that the centre of gravity is kept as low as possible.

Crossbars must be removed when putting vehicle through an automatic car wash.

Carrying Loads: Use only non-stretch fastening ropes or straps to secure your load.

Caution: The handling characteristics of the vehicle change when you transport a load on the roof. For safety reasons we recommend you exercise extreme care when transporting wind-resistant loads. Special consideration must be taken into account when cornering and braking.

Load Ratings:

Maximum permissible load is 68kg (149lbs) for two crossbars including the weight of the crossbars, 5kg (11lbs). When crossbars are to be used in off-road conditions, please build a safety factor of 1.5 into this load limit for off-road use, two crossbars = **45kg (99lbs)**. Although the crossbars are tested and approved to AS1235-2000, off-road conditions can be much more rigorous. However, increasing the number of crossbars does not increase the vehicles maximum permissible roof loading.

Note for Dealers and Fitters:

It is your responsibility to ensure instructions are given to the end user or client.

Rhino-Rack
3 Pike Street, Rydalmere,
NSW 2116, Australia.
(Ph) (02) 9638 4744
(Fax) (02) 9638 4822

Document No: R163
Prepared By: Scott Murray
Authorised By: Chris Murty

Issue No: 07
Issue Date: 14/07/2015

These instructions remain the property of Rhino-Rack Australia Pty. Ltd. and may not be used or changed for any other purpose than intended.



RHINO-RACK

WARNING!

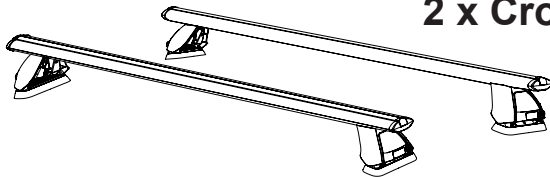
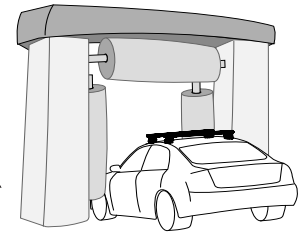
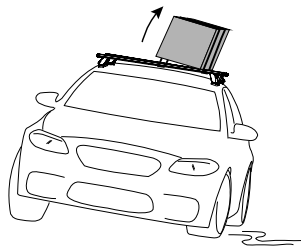
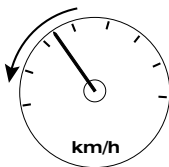
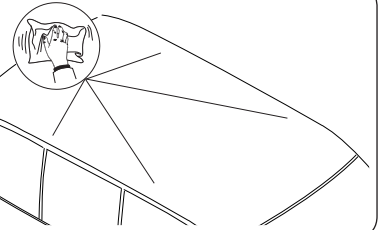
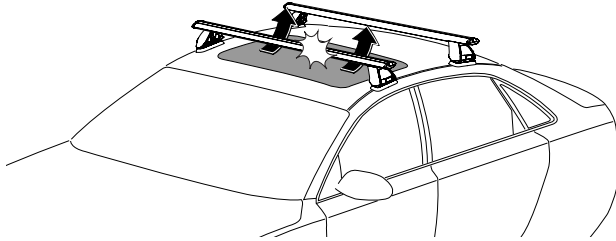
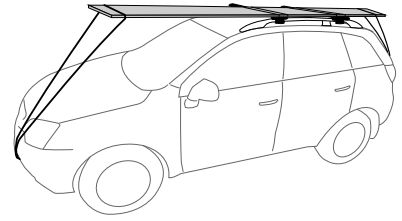
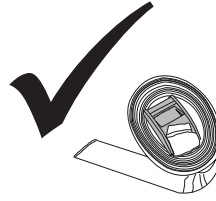
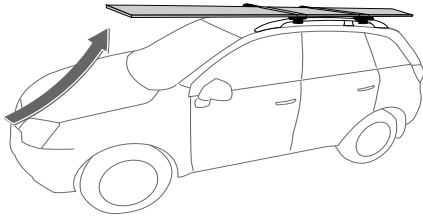

2 x Crossbars = 5kg



? kg

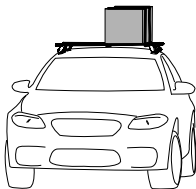
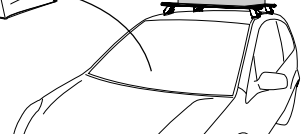

Max. 68kg/149lbs = **Max. 45kg/99lbs**
Urban road Off road

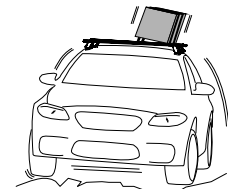

WARNING! Important Load Carrying Instructions

With utility vehicles, the cabin and the canopy move independently. Roof racks and vehicle can be damaged if the item transported is rigidly fixed at points on both the cabin and canopy. Instead, rigidly fix to either the cabin roof racks or the canopy roof racks.

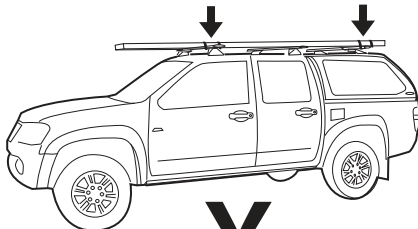

X NO

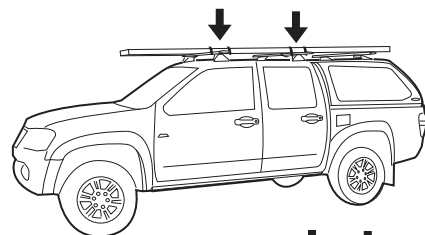

✓ YES

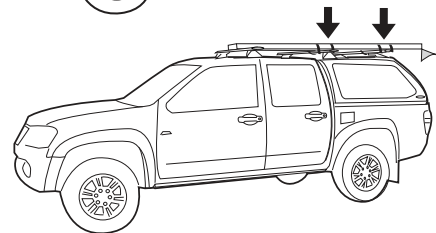

✓ YES

- Please refer to your vehicle manufacturers handbook for maximum roof load capacity.
- Any load transported on Roof Racks must be evenly distributed.
- Instructions are to remain with the vehicle.
- Do not attempt to fit the roof racks to your vehicle unless you fully read and understand the fitting instructions provided.
- Please direct any questions to the dealer from where the roof racks were purchased.
- Check the contents of this kit before commencing fitment and report any discrepancies.



Jeep Grand Cherokee (RSP27)

Parts List

Item	Component Name	Qty	Part No.
1	Crossbars: Front 913mm Rear 875mm	2	A155
2	Vortex Rubber	5	M626
3	M6 x 25mm Security Screw	6	B137
4	M6 Spring Washer	10	W004
5	M6 x 20mm Button Security	4	B062
6	Front Bracket	2	CA1337
7	Rear Bracket	2	CA1338
8	M6 x 12.5mm Flat Washer	10	W003
9	RSP Leg (47mm)	4	M509
10	10G x 1/2" Pan Head Phillips Screw	4	B045
11	Rubber Skirt	4	M725
12	5mm Allen Key	1	H021
13	Instruction	1	R163

Tools Required.

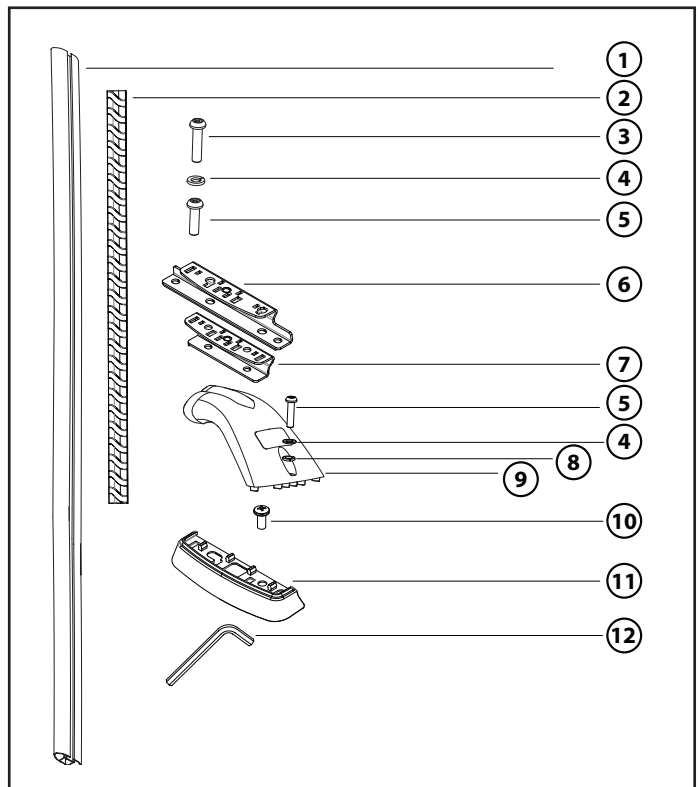
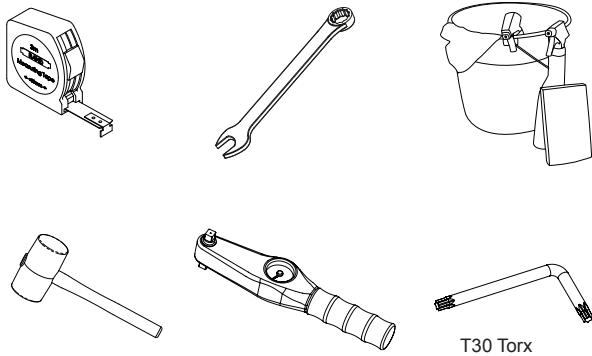

1 Move to the mounting point in the roof toward the front right of the vehicle.

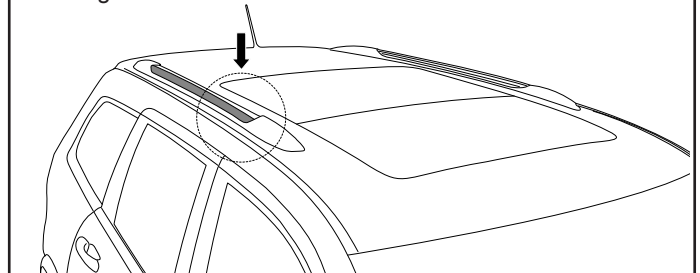

2 Top View: Locate the mounting point factory hardware.

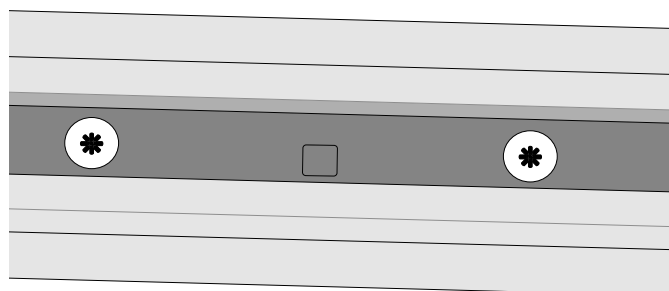

3 Using a T30 key, remove factory hardware. Retain for replacement if roof rack is ever removed.

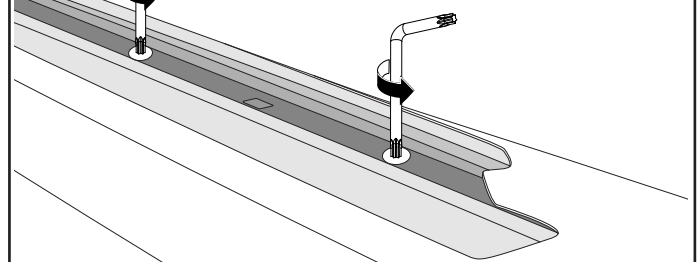

4 Push the rubber skirt into both front brackets

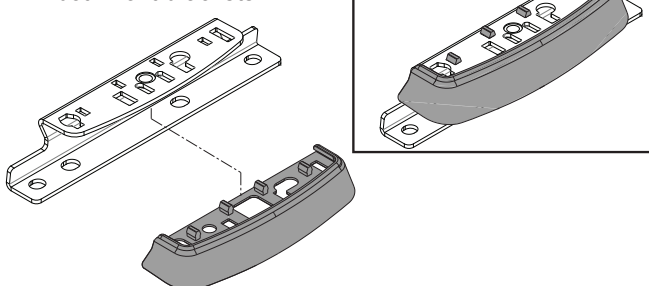

5 Place the Front Bracket over the exposed threads.

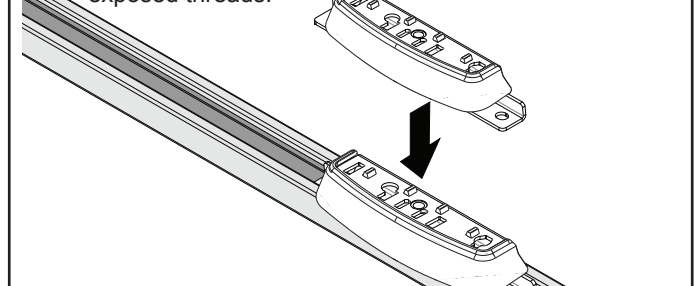



Jeep Grand Cherokee (RSP27)

- 6** Install the bracket using M6 x 25mm Security Screws, M6 Spring and Flat Washers. Finger tighten. The foam base on each bracket can easily be pierced using the hardware provided.

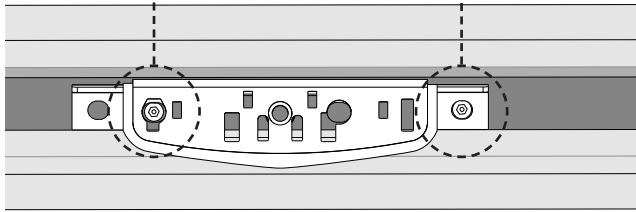
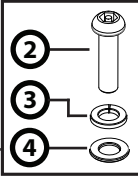

REAR

Note: Front Right Bracket shown.

FRONT

- 7** Use the allen key provided, tighten to 4-5Nm (3-4 lb/ft).

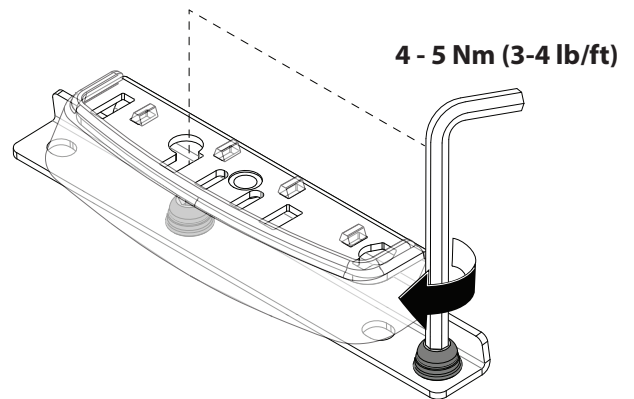

- 8** Remove the factory hardware at the rear mounting point using a T30 Torx key.

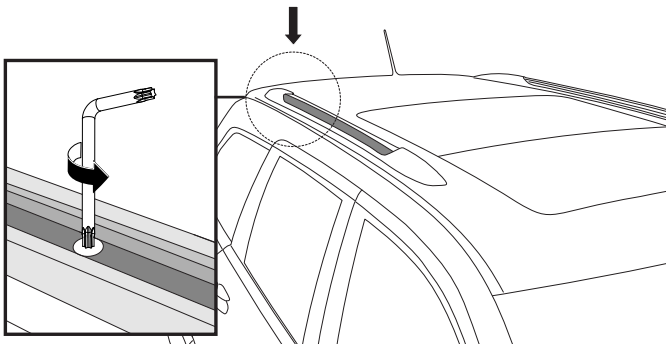

- 9** Push the rubber skirt into both rear brackets.

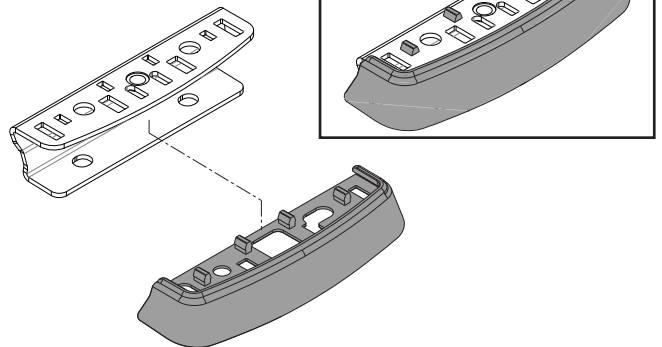

- 10** Place the Rear bracket in position above the newly exposed thread.

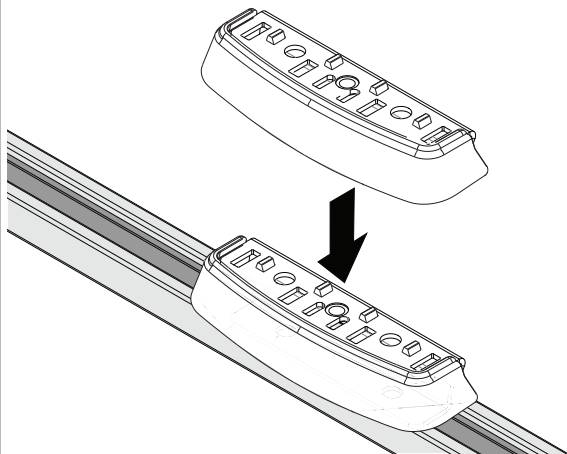

- 11** Install the bracket using an M6 x 25mm Security Screw, M6 Spring and Flat Washers. Finger tighten.

Top View:

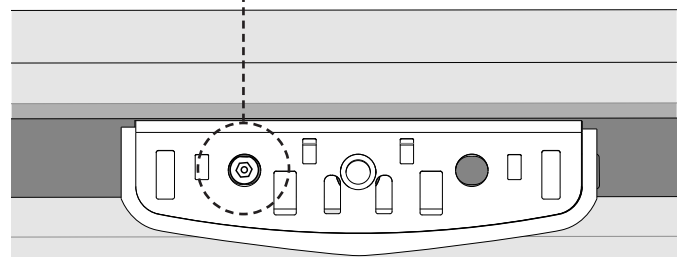
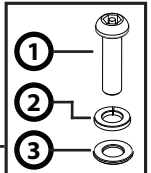

REAR

FRONT

- 12** Use the allen key provided and tighten to 4-5Nm (3-4 lb/ft).

4 - 5 Nm (3-4 lb/ft)

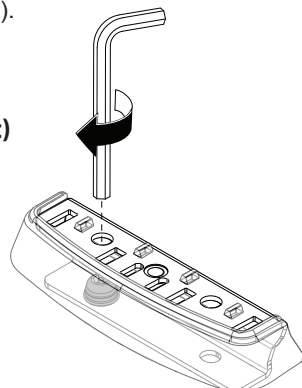

- 13** Move to the mounting points in the roof toward the front left of the vehicle.

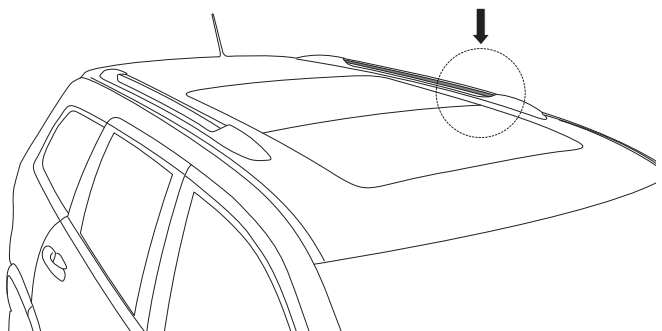



Jeep Grand Cherokee (RSP27)

- 14** Top View: Locate the two factory mounting points.

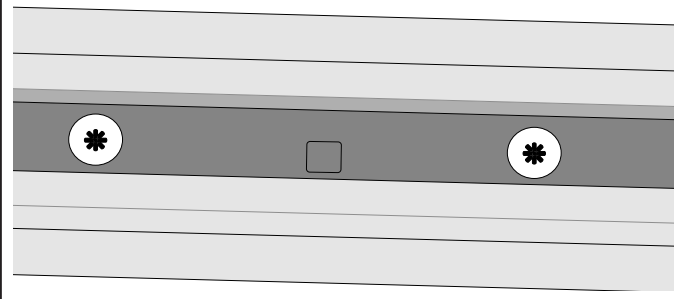

- 15** Using a T30 Torx key, remove factory hardware.

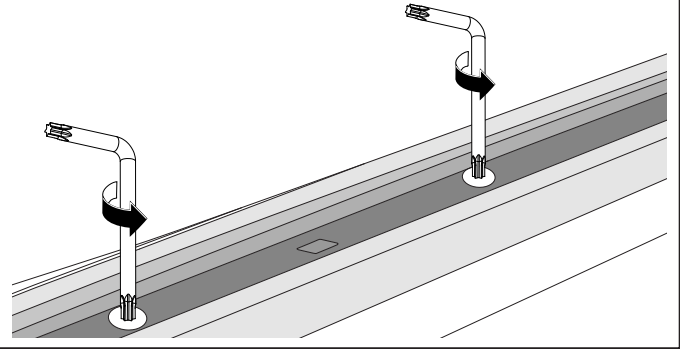

- 16** Place the Front Bracket over the exposed threads.

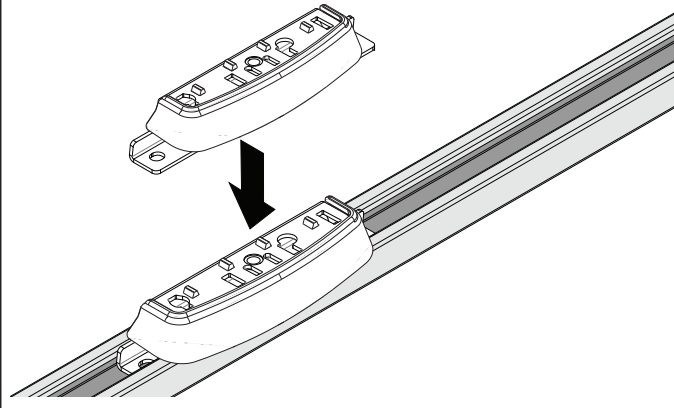

- 17** Install the bracket using M6 x 25mm Security Screws, M6 Spring and Flat Washers. Finger tighten. The foam base on each bracket can easily be pierced using the hardware provided.

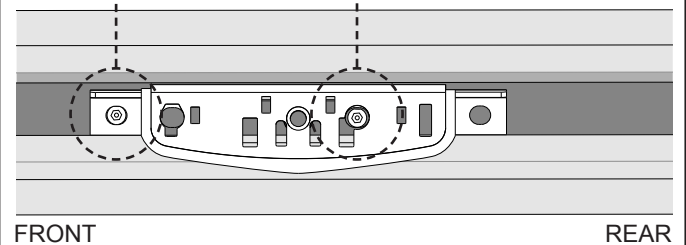
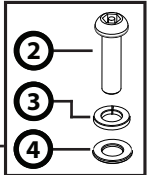

- 18** Remove the factory hardware at the Rear Left mounting point using a T30 Torx key.

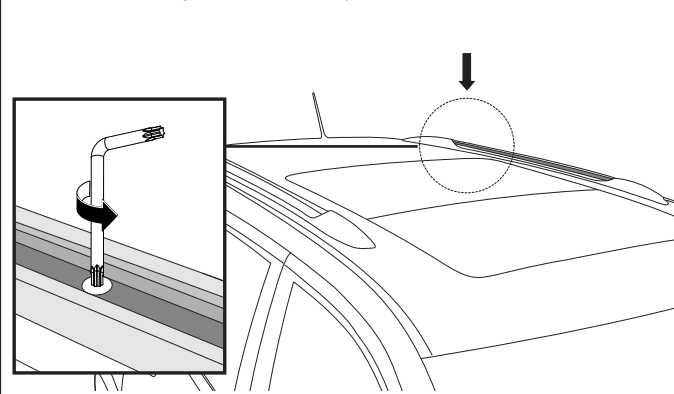

- 19** Place the Rear bracket in position above the newly exposed thread.

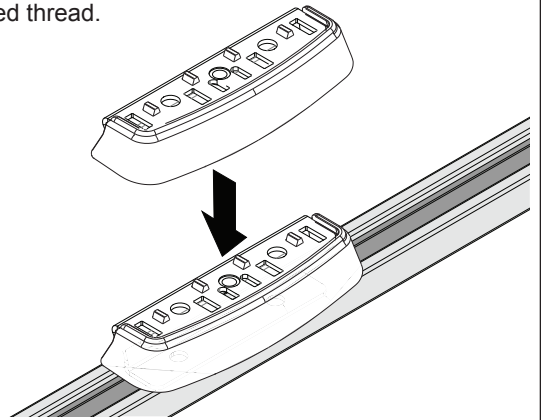

- 20** Install the bracket using an M6 x 25mm Security Screw, M6 Spring and Flat Washers. Finger tighten.

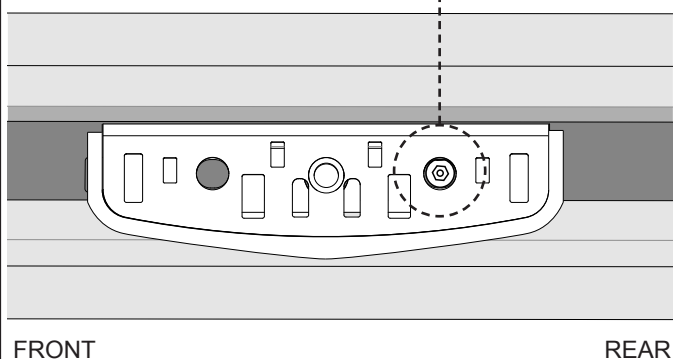
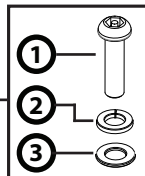

- 21** Use the allen key provided and tighten to 4-5 Nm (3-4 lb/ft).

4 - 5 Nm (3-4 lb/ft)

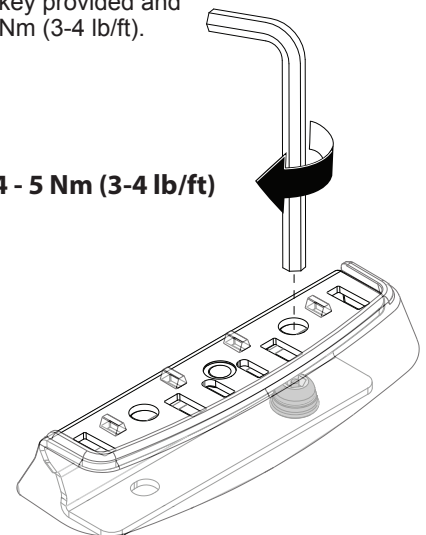



Jeep Grand Cherokee (RSP27)

- 22** Insert the support leg fully into the crossbars, a rubber mallet may be required to knock the leg in place.

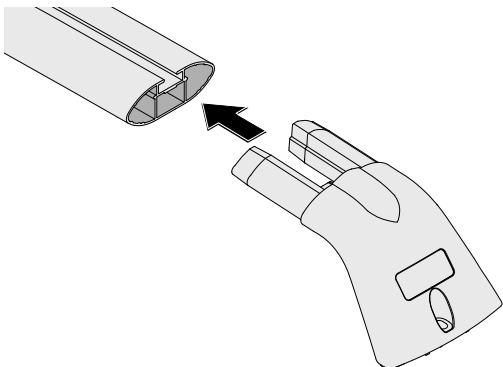

- 23** From the underside of the crossbar insert the phillips head screw.

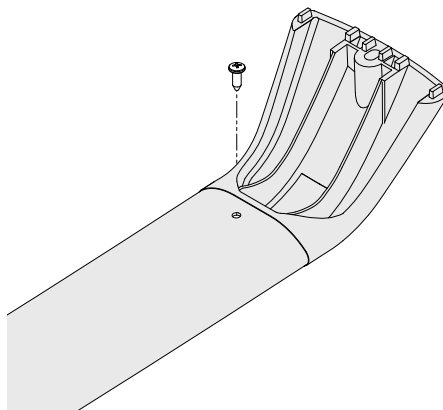

- 24** Insert Vortex Rubber into crossbar.

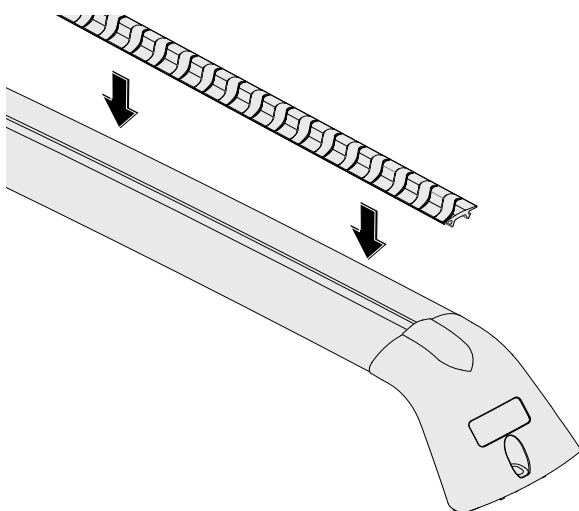

- 25** Install crossbars using an M6 x 20mm Security Screw, M6 Spring Washer and M6 Flat Washer. Tighten with Allen Key provided to 3-4 Nm/ 2-3lb/ft. Check fittings are secure.

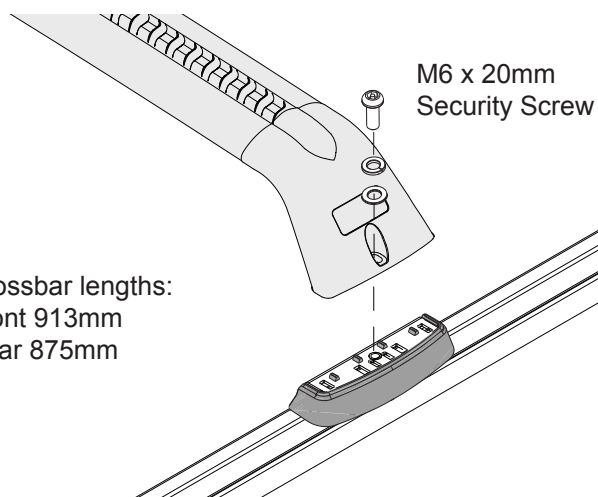

Crossbar lengths:
Front 913mm
Rear 875mm

Check all fixtures are secure