



RHINO-RACK

CONTROLLED

Holden Colorado 7 - Chevrolet Trailblazer

RLCP32 Crossbar System

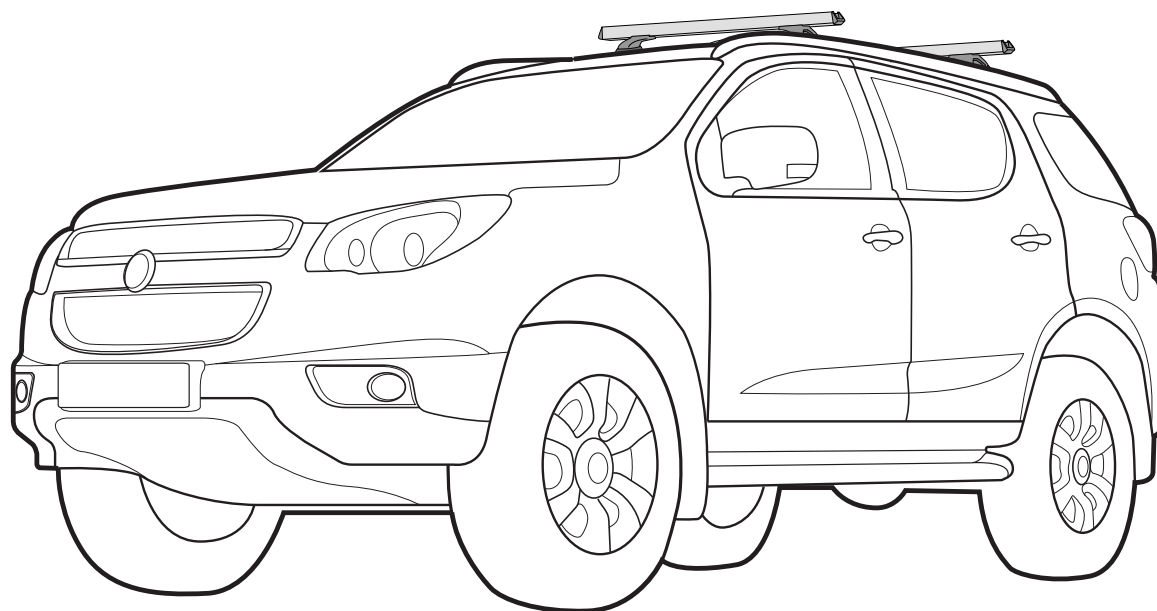

Important Information

Maximum Load Capacity: 100kg (220lbs) evenly distributed over two or three crossbars.

Recommendations:

It is essential that all bolt connections be checked after driving a short distance when you first install your crossbars. Bolt connections should be checked again at regular intervals (probably once a week is enough, depending on road conditions, usage, loads and distances travelled). You should also check the crossbars each time they are refitted. Make sure to fasten your load securely. Please ensure that all loads are evenly distributed and that the centre of gravity is kept as low as possible. Always use non stretch ropes.

Please remove crossbars when putting vehicle through an automatic car wash.

Load Ratings:

Maximum permissible load is 100kg (220lbs) for two and three crossbars including the weight of the crossbars, 5kg (11lbs) for two crossbars, 7.5kg (16lbs) for three crossbars. When crossbars are to be used in off-road conditions, please build a safety factor of 1.5 into this load limit for off-road use, two and three crossbars = **66kg 145lbs**). Although the crossbars are tested and approved to AS1235-2000, Off road conditions can be much more rigorous. However, increasing the number of crossbars does not increase the vehicles maximum permissible roof loading.

Note for Dealers and Fitters:

It is your responsibility to ensure instructions are given to the end user or client.

Rhino-Rack
3 Pike Street, Rydalmere,
NSW 2116, Australia.
(Ph) (02) 9638 4744
(Fax) (02) 9638 4822

Document No: R444
Prepared By: Kayle Everett
Authorised By: Chris Murty

Fit Time: 1 Hour
Issue No: 05
Issue Date: 01/02/2017

These instructions remain the property of Rhino-Rack Australia Pty. Ltd. and may not be used or changed for any other purpose than intended.



RLCP32

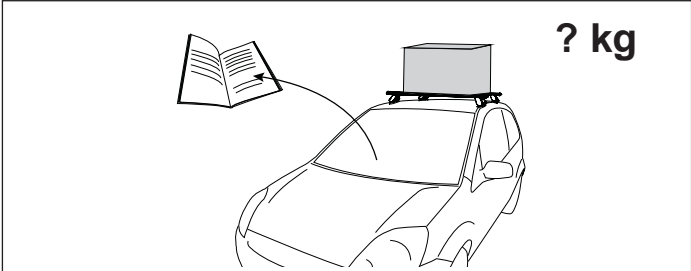
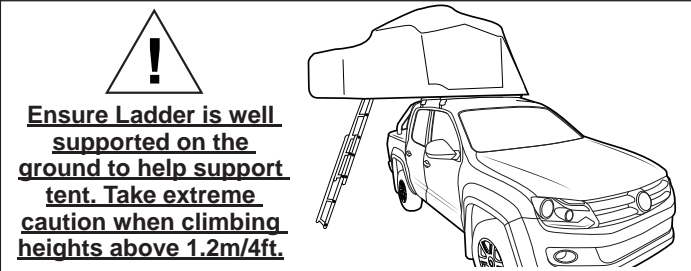
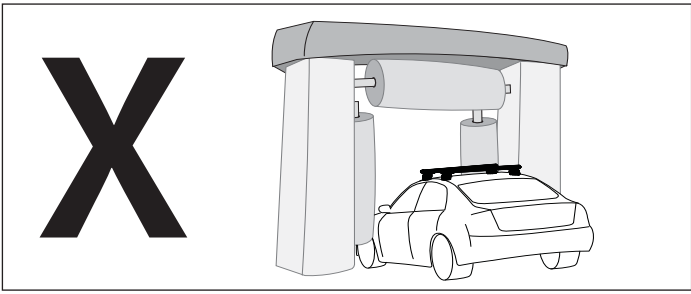
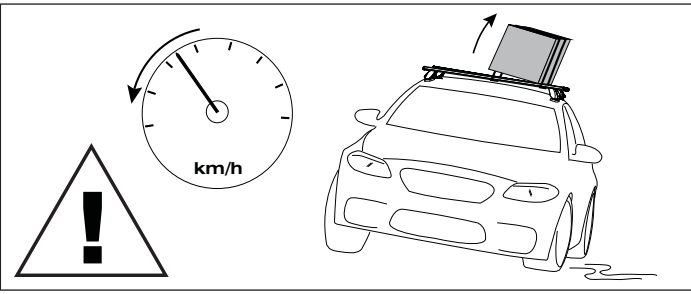
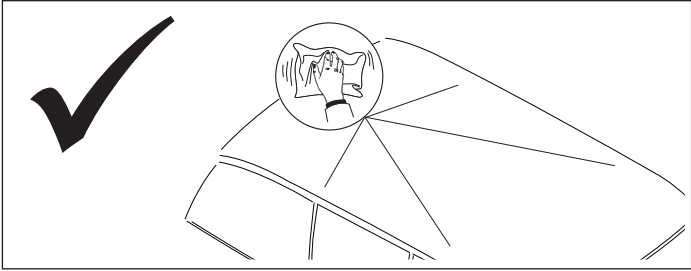
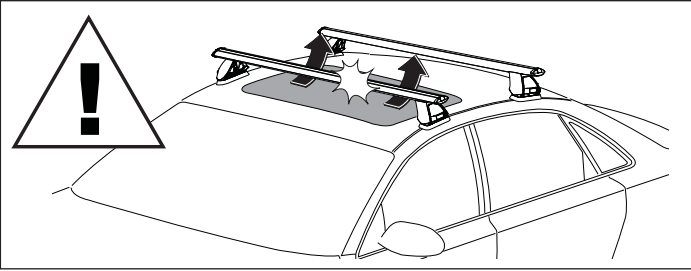
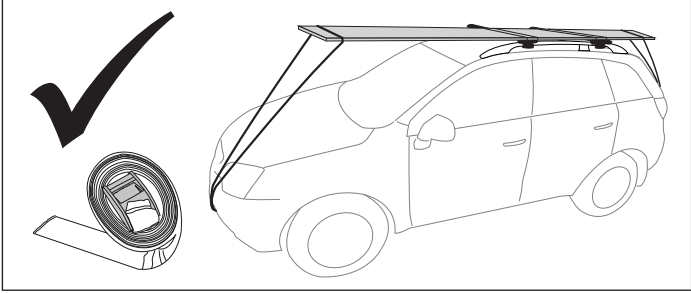
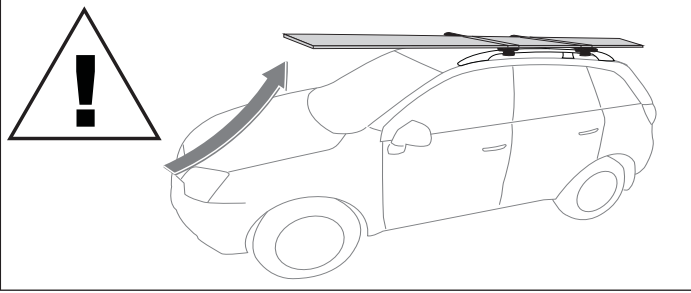

When these roof racks are to be used on a vehicle that is driven off sealed roads, the maximum roof rack load rating should be **divided by 1.5**. Do not forget to subtract 5kg from your maximum carrying capacity due to the weight of the crossbars and legs.

100kg/220lbs	=	66kg/145lbs
(Urban road)		(off-road)

WARNING! Important Load Carrying Instructions

With utility vehicles, the cabin and the canopy move independently. Roof racks and vehicle can be damaged if the item transported is rigidly fixed at points on both the cabin and canopy. Instead, rigidly fix to either the cabin roof racks or the canopy roof racks.

X NO (Incorrect: Rigidly fixed to both cabin and canopy)

YES (Correct: Rigidly fixed to either cabin or canopy)

Paddle/ Surfboards should be fixed to the front of the vehicle.



RLCP32

Parts List

Item	RLCP32	Qty	Part No.
1	RLCP Bracket	4	CA1309
2	Rubber Skirt	4	M725
3	M10 Channel Nut	4	N024
4	M6 x 16mm Security Torx Screw	12	B242
5	M6 Spring Washer	12	W004
6	M6 x 12.5mm Flat Washer	12	W003
7	RLCP Leg	4	M123
8	M10 x 38mm X 2.5mm Flat Washer	4	W022
9	M10 Shake Proof Washer	4	W021
10	M10 x 25mm Hex Set Screw	4	B071
11	T27 Security Torx Key	1	H054
12	Fitting Instructions	1	R444

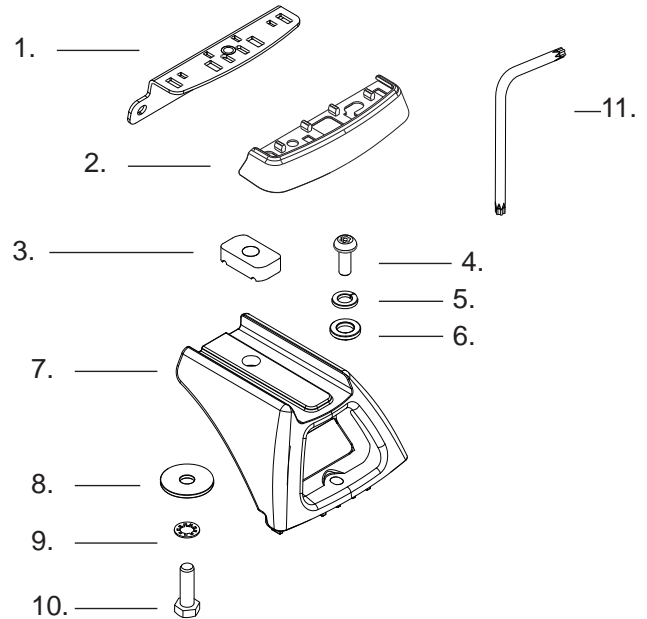

Crossbars sold individually	Part No.
1250mm Heavy Duty Crossbar SILVER	RB1250S
1250mm Heavy Duty Crossbar BLACK	RB1250B
1260mm Vortex Crossbar SILVER	VA126S
1260mm Vortex Crossbar BLACK	VA126B

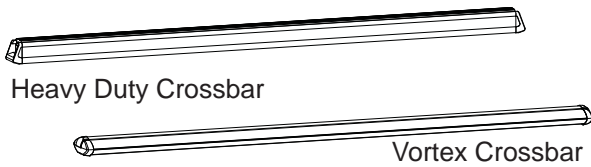

Tools Required:

- 1- 10mm Spanner.
- 2- 5/8 or 16mm Spanner.
- 3- Utility Knife.
- 4- Tape Measure.
- 5- Torque Wrench.

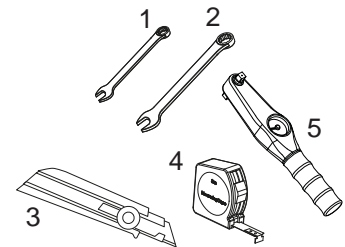

Fitting Instructions

- 1** Install the mounting bracket onto the rubber skirt. Note that the four locking tabs on the rubber skirt push through and fix onto the bracket.

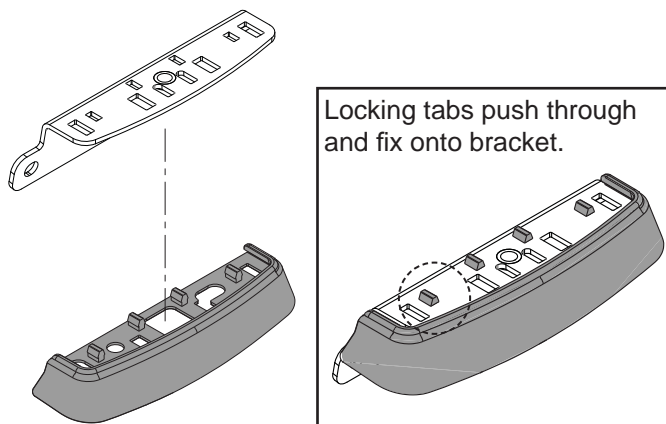

- 2** Install the completed mounting bracket onto the roof rails. Fixture points are located on both rails facing inward.

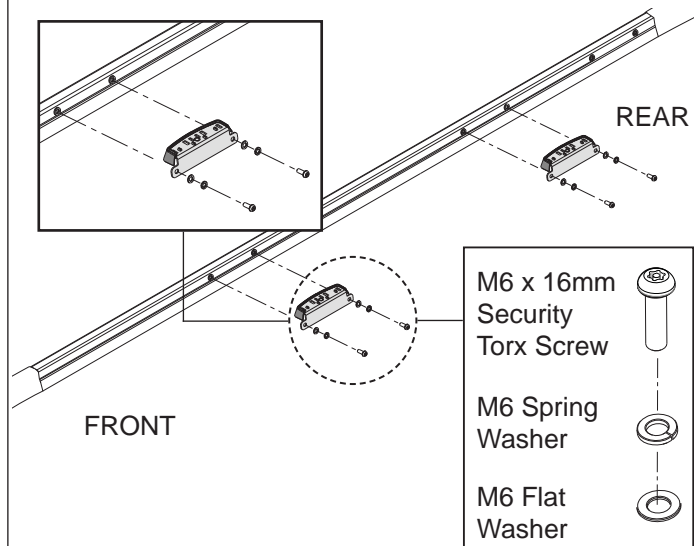



RLCP32

Heavy Duty Crossbar installation

Note Three Heavy Duty Crossbars.

Leg height spacers are used to maintain a level height across three crossbars.

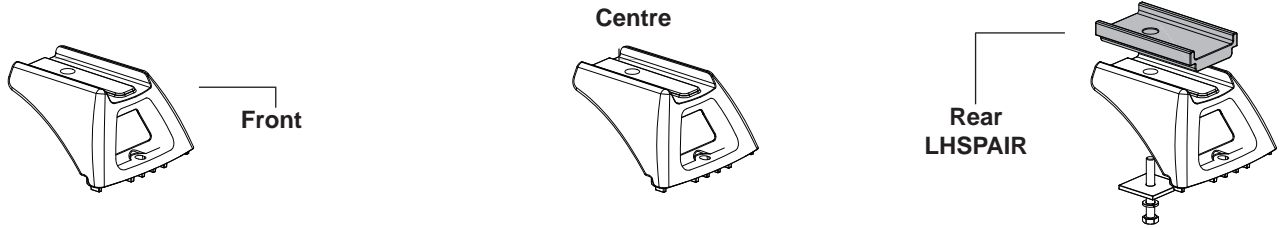

3 Two Heavy Duty Crossbars.

Two crossbars can be positioned on any of the roof rack mounting points. All of the required hardware is supplied within this kit.

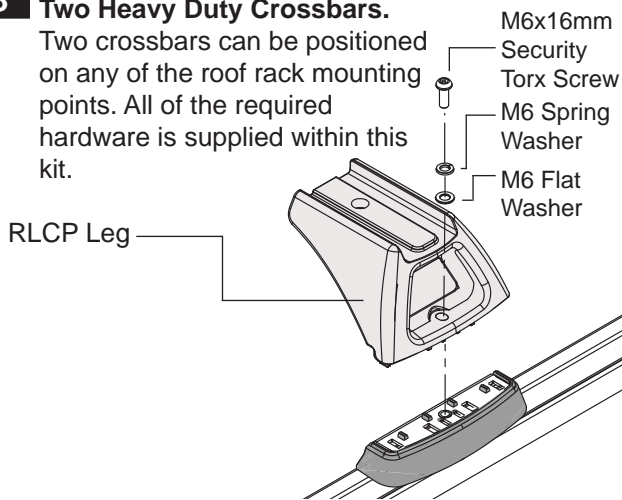

4

Install the M10 Channel Nut with an M10 Hex Bolt, M10 Shake Proof Washer and M10 Flat Washer. Do not tighten at this stage.

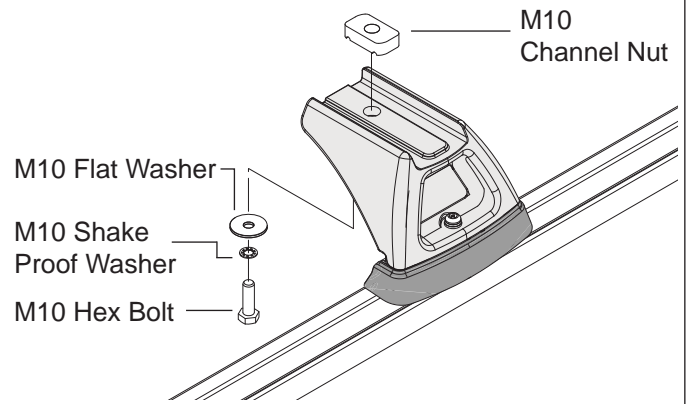

5 Place the Heavy Duty Bar over the Channel Nut and locate the nut into a fixed position. Finger tighten.

IMPORTANT: Locate the channel nut across the bar.

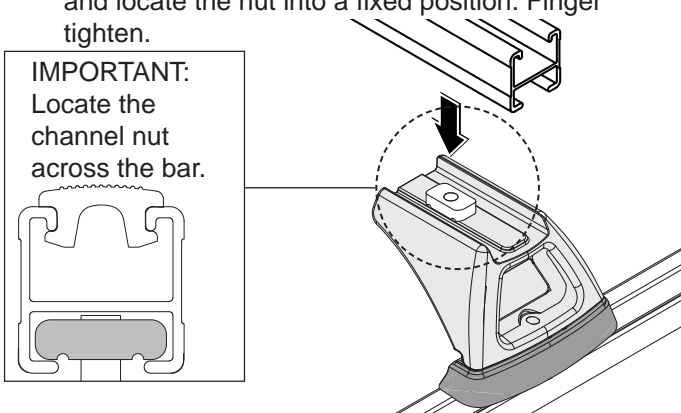

6

Insert rubber buffer strip and end caps.

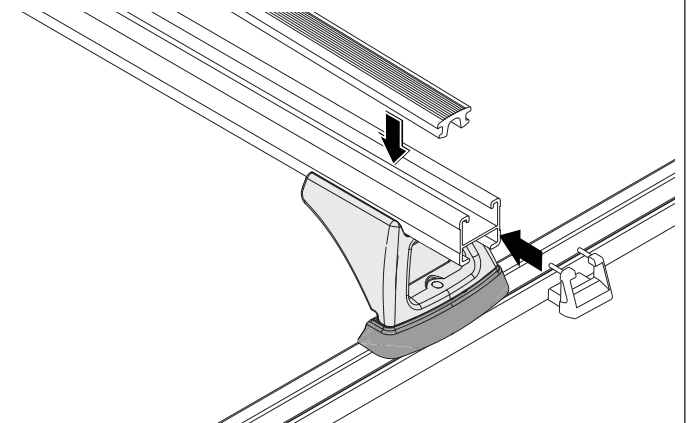

7

Adjust Crossbar overhang to be equal on both sides. Tighten M10 Crossbar Bolts with a wrench to 9-10Nm/ 6-7lb/ft. Tighten M6 Security Torx Screws with the T27 Torx Key provided to 3-4Nm/ 2-3lb/ft. Check fittings are secure.

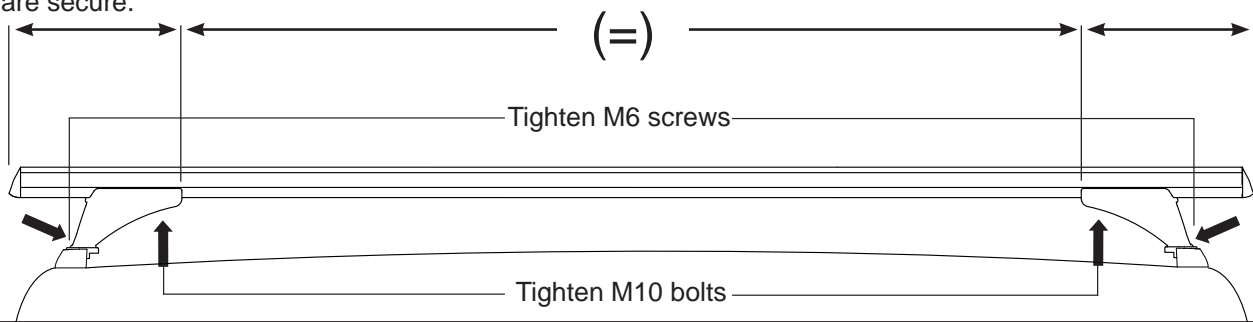



RLCP32

Vortex Crossbar installation

1a

Two Vortex Crossbars.

Two crossbars can be positioned on any of the roof rack mounting points.

When fitting two Vortex crossbars you will need 2 x VA-FK2 fitting kits which are sold separately.

VA-FK2 components for Vortex crossbars

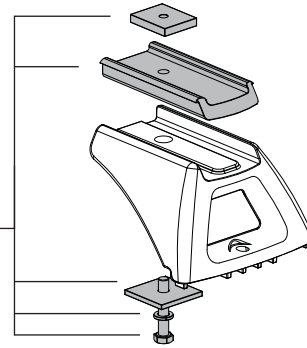

1b

Three Vortex Crossbars.

Leg height spacers are used to maintain a level height across three crossbars.

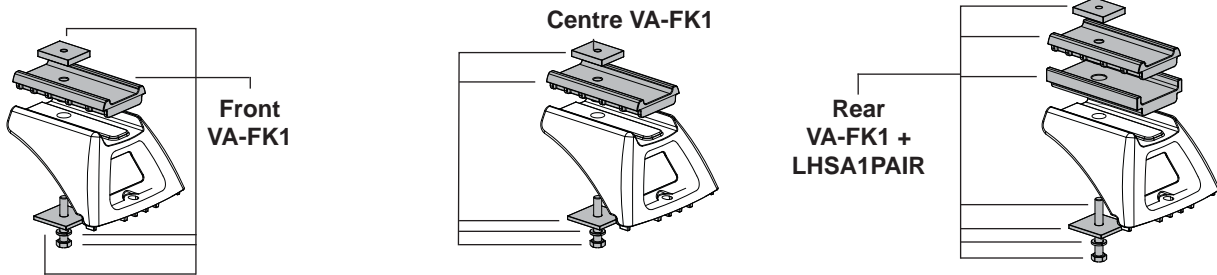

2

Install the leg as shown.

RLCP Leg

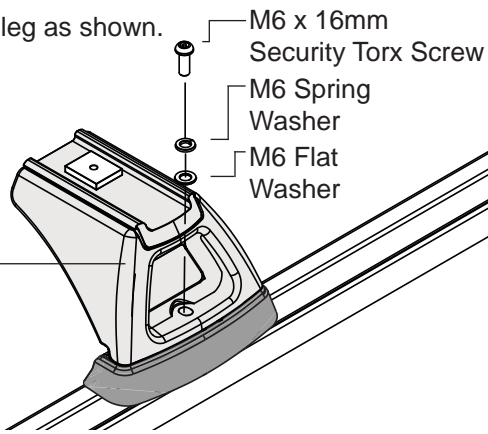

- M6 x 16mm Security Torx Screw
- M6 Spring Washer
- M6 Flat Washer

3

Slide the crossbar over the square nut, finger tighten.

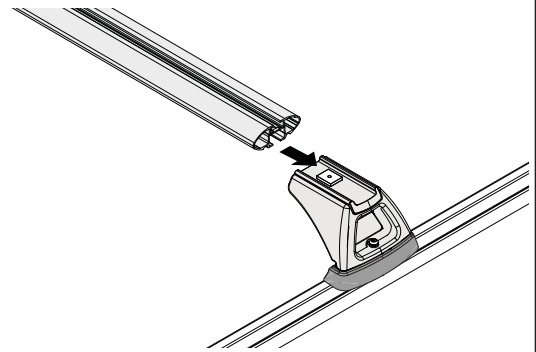

4

Adjust Crossbar overhang to be equal on both sides. Tighten M6 Crossbar Bolts to 3-4Nm/ 2-3lb/ft. Tighten M6 Security Torx Screws with the T27 Torx Key provided to 3-4Nm/ 2-3lb/ft. Check fittings are secure.

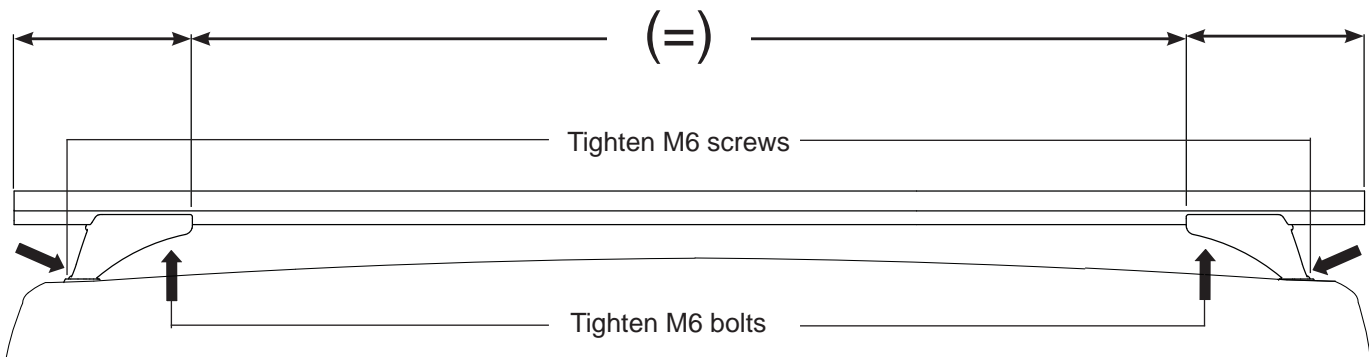



RLCP32

- 5** Measure the underbar slot length each side of the leg then cut the bar measurement strips to these lengths. Clip each piece into the underbar slots of the crossbar. Filling these slots helps to reduce or eliminate wind noise.

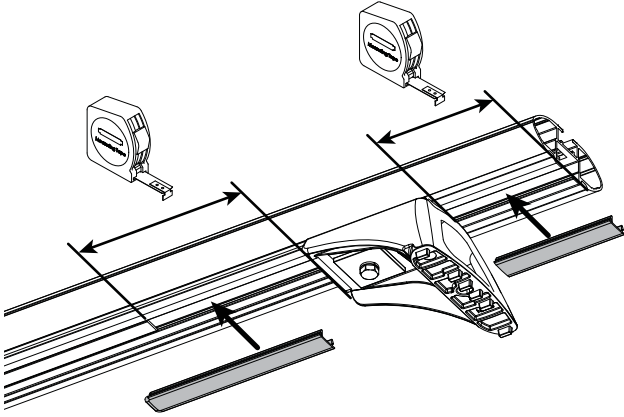

- 6** Insert the Vortex buffer strips and end caps into each crossbar. Cut strips to suit crossbar length.

