

# RHINO-RACK

## Toyota Tundra Double Cab Backbone - RTTB3

Fit Time: 1 Hour

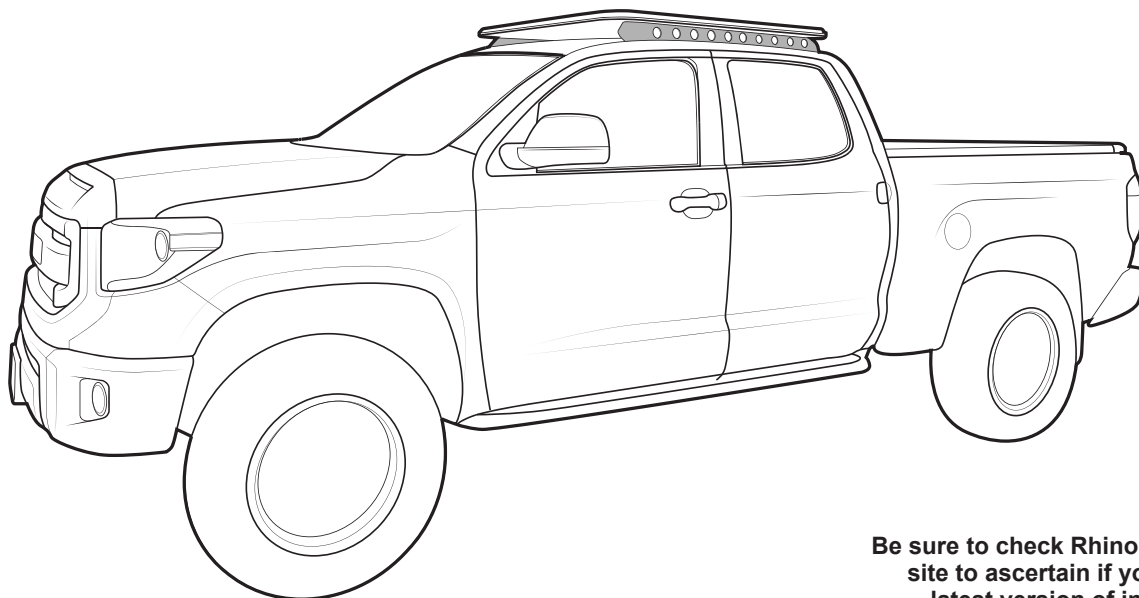

Be sure to check Rhino-Rack website to ascertain if you have the latest version of instructions.

### IMPORTANT INFORMATION

#### Maximum carrying capacity:

Suitable Pioneers	On Road Cargo Allowance	Off Road Cargo Allowance	Static Allowance	Roof Allowance	Rack Weight
42113B	70kg / 155lb	50kg / 110lb	330kg / 728lb	100kg / 220lb	30kg / 66lb

**Roof Allowance:** Total permissible weight attached to the roof of the car. This is inclusive of the weight of the roof rack system

**Cargo Allowance:** Total permissible weight allowed on top, and attached to roof racks whilst the vehicle is in motion

**Static Allowance:** Total permissible weight allowed on top, and attached to roof racks whilst the vehicle is stationary

Please refer to your vehicle manufacturers handbook for maximum carrying capacity. Always use the lower of the two figures. Load must be evenly distributed over the entire Pioneer. Weight of roof rack accessories is to be included in cargo allowance.

#### Torque settings

Unless stated otherwise in these instructions, all fasteners should be set to the following torque settings -

M6: 4-5Nm (3-4lbs/ft), M8: 8-10Nm (6-7.5lbs/ft) and M10: 16-18Nm (12-13lbs/ft).

#### Warning:

- Check Part No. and/ or Kit is correct for use with your vehicle
- Do not attempt to fit the rack system to your vehicle unless you fully understand these fitting instructions. Please direct any questions regarding fitting to the dealer from where the roof racks were purchased.
- **Use only non-stretch fastening ropes or straps.**
- The handling characteristics of the vehicle changes when you transport a load on the roof. For safety reasons we recommend you exercise extreme care when transporting wind-resistant loads. Special consideration must be taken into account when cornering and braking.
- Although the system is tested and approved to AS1235-2000 / ISO 11154, off-road conditions can be much more rigorous. Extreme care must be taken in off road conditions

#### Recommendations:

It is essential that all bolt connections be checked after driving a short distance when you first install your roof racks. Bolt connections should be checked again at regular intervals (once a week is enough, depending on road conditions, usage, loads and distances travelled). You should also check the roof racks each time they are re-fitted. Always make sure to fasten your load securely. Please also ensure that all loads are evenly distributed and that the centre of gravity is kept as low as possible and must be entirely contained within the extents of the roof racks.

#### Note for Dealers and Fitters:

It is your responsibility to ensure these fitting instructions are given to the end user or client. Always check the Rhino-Rack website to be sure you have the most up to date instructions.

Rhino-Rack, 22 Hanson St, Eastern Creek  
NSW 2766, Australia  
(02) 8846 1900  
rhinorack.com.au

Document No: R1827  
Prepared By: Kayle Everett  
Authorised By: Sam Whelan

Issue No: 02  
Issue Date: 16/08/2018

These instructions remain the property of Rhino-Rack Australia Pty. Ltd. and may not be used or changed for any other purpose than intended.

## Toyota Tundra Double Cab Backbone - RTTB3

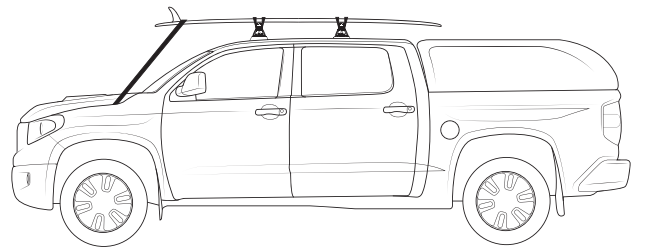
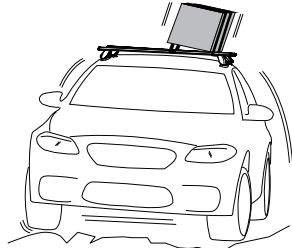
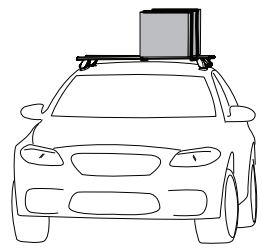
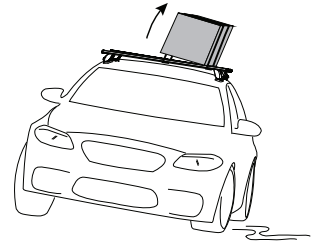
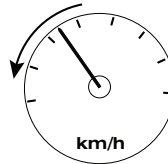
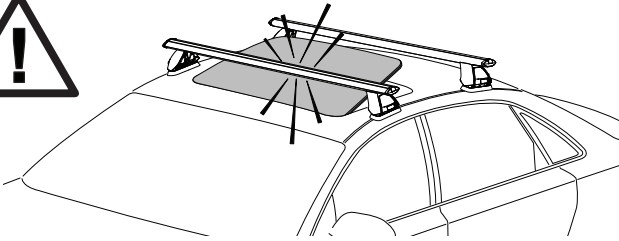
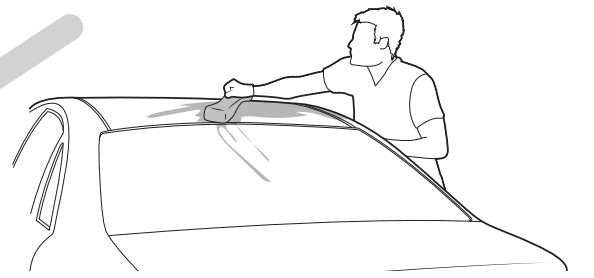
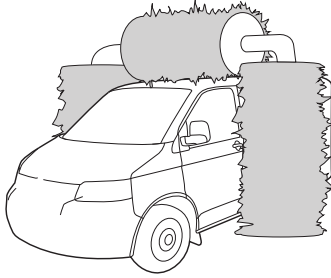
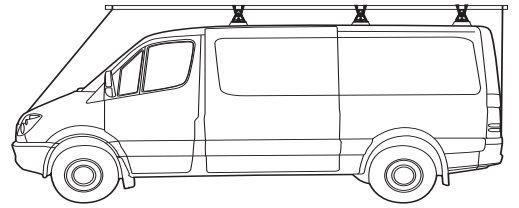
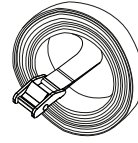
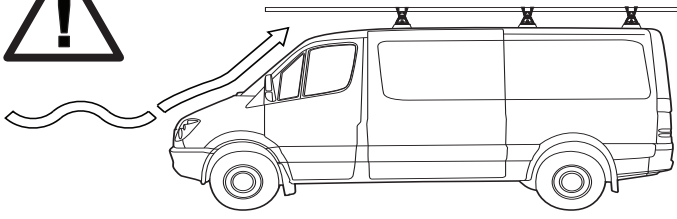

**System Weight: 30kg / 66lbs**

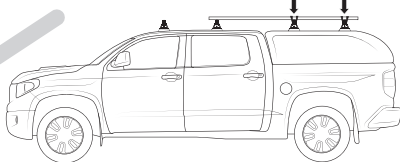
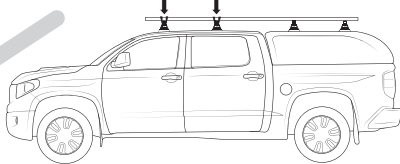
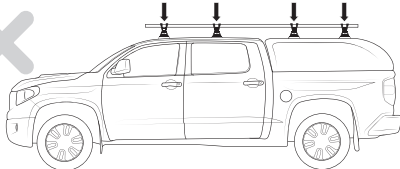
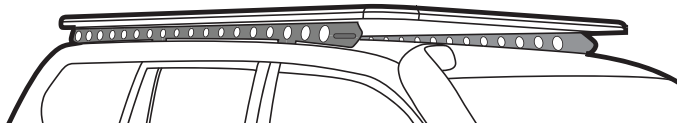

**Ensure Ladder is well supported on the ground to help support tent. Take extreme caution when climbing heights above 1.2m/4ft.**

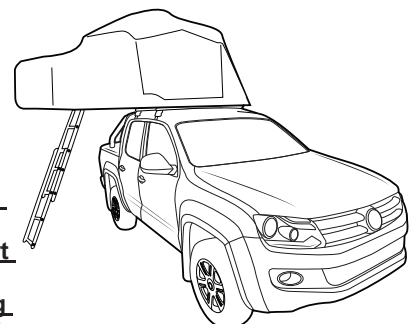

# Toyota Tundra Double Cab Backbone - RTTB3

## Parts List

Item	RFRB2	Qty	Part No.
1	Tundra DCAB Backbone LH	1	CA1919
2	Tundra DCAB Backbone RH	1	CA1920
3	M8 x 20mm Hex Bolt	6	B020-BLK
4	M8 Spring Washer	6	W019-BLK
5	M8 x 24mm Flat Washer	6	W064-BLK
6	M8 Channel Nut	6	N003-BLK
7	Backbone Allen Key	1	H058
8	M6 x 20mm SKT Head Screw	12	B054
9	M6 Spring Washer	12	W004
10	M6 12.5mm Flat Washer	12	W003
11	Butyl Patch 20x20mm	12	CA1266
12	M6 Rivnut	12	N070
13	Instructions	1	R1827

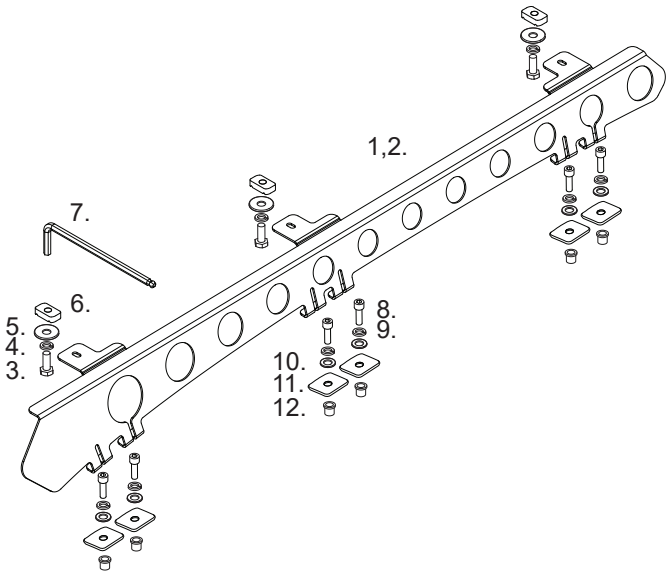

### Tools Required

- A. Power Drill
- C. 3mm Drill Bit
- E. Marker
- G. Drill Stop
- I. 13mm Wrench
- L. 9mm Drill Bit
- B. Centre Punch
- D. Measuring Tape
- F. Metric Rivnut Tool
- H. Galvanising Paint
- K. Vacuum

## Instructions

1

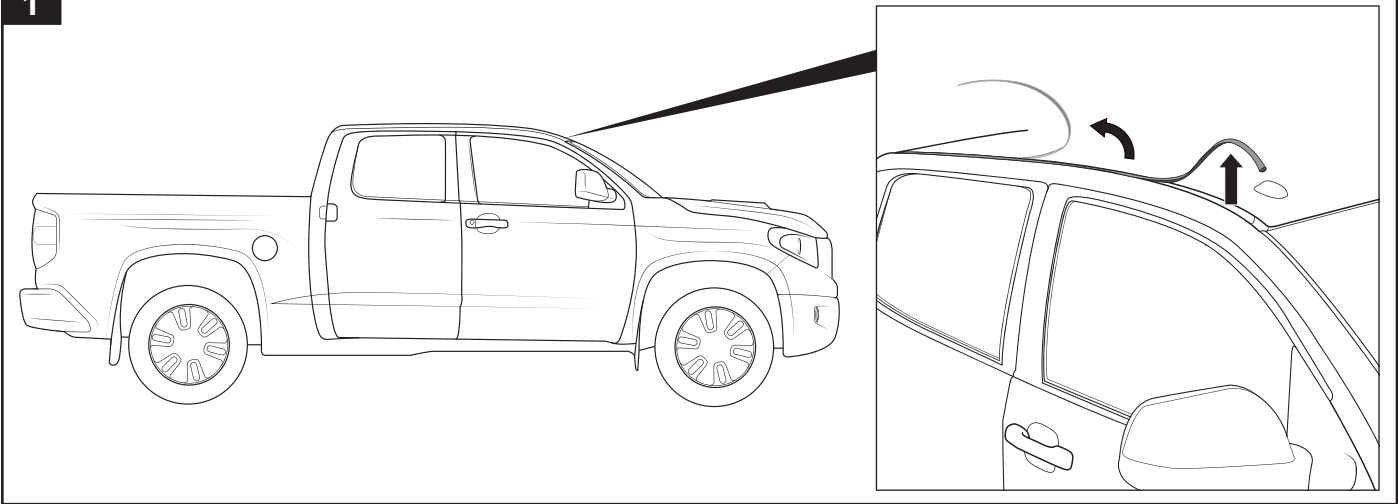

2

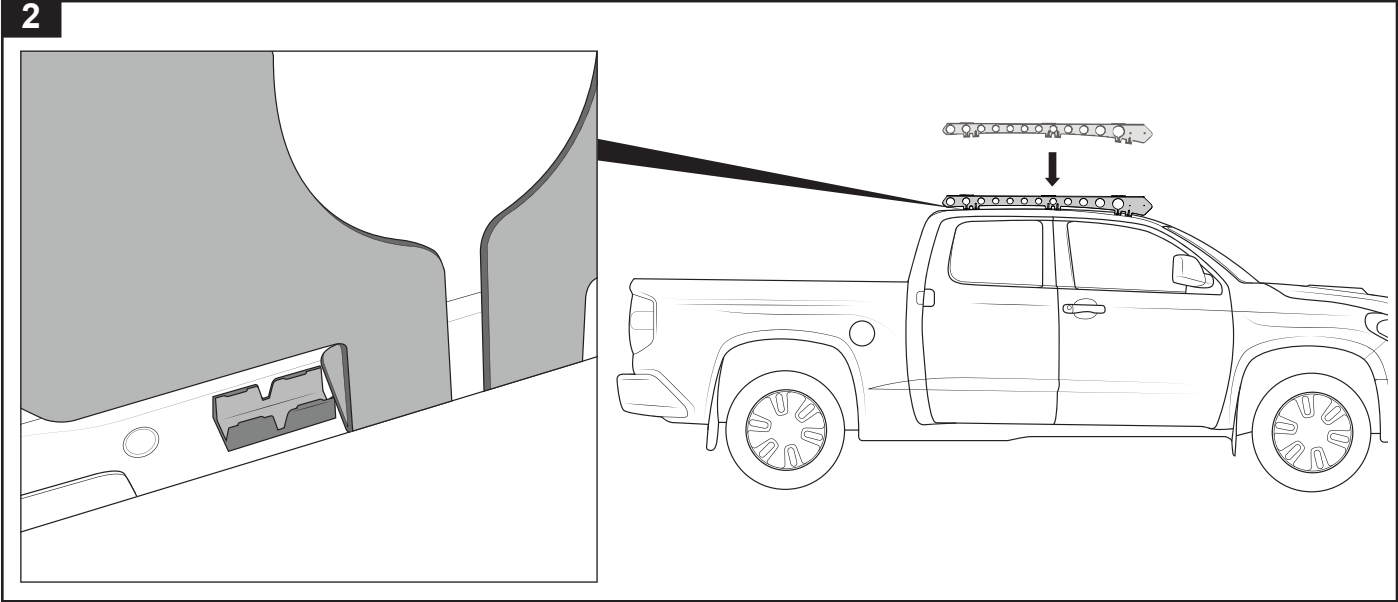

Toyota Tundra Double Cab Backbone - RTTB3

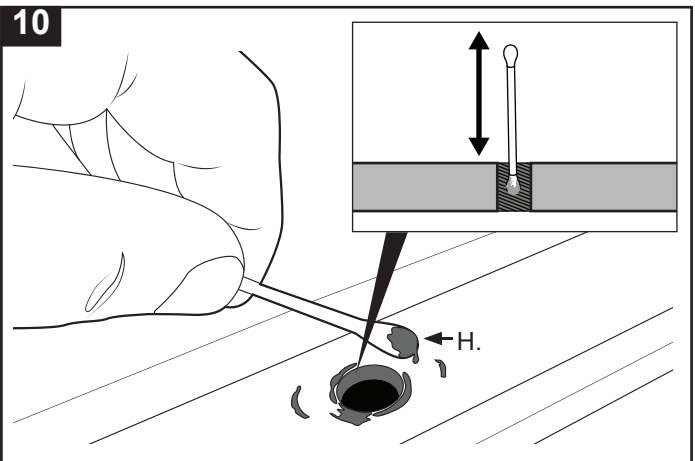
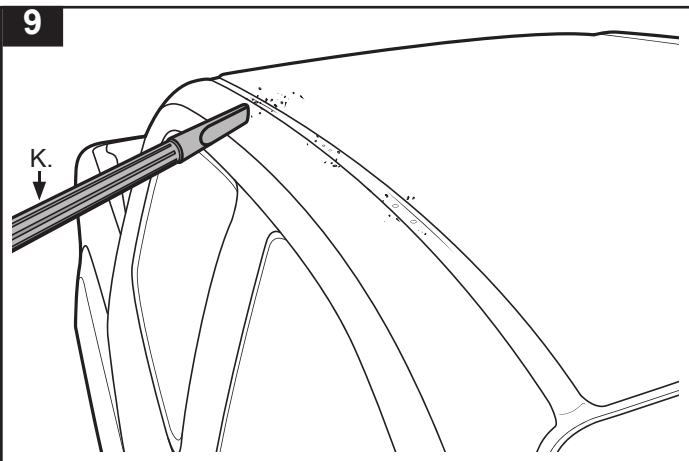
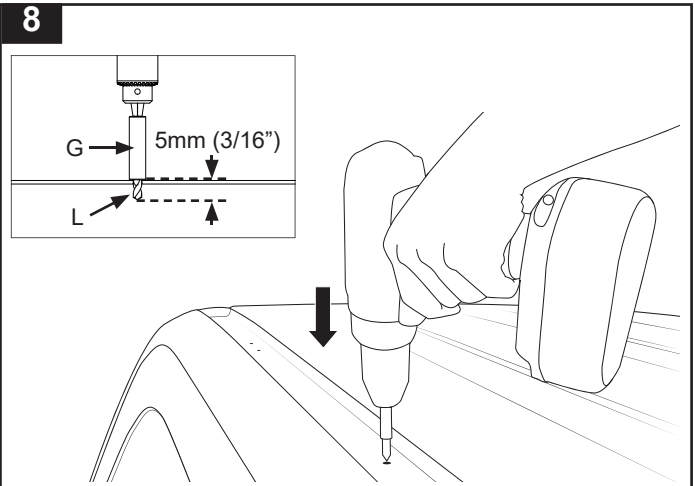
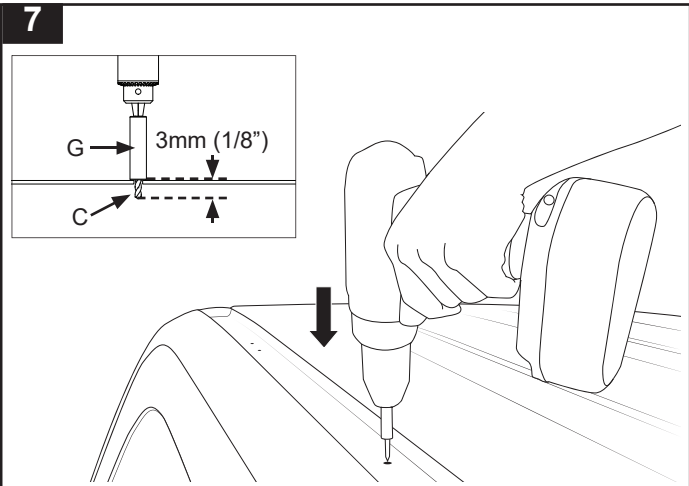
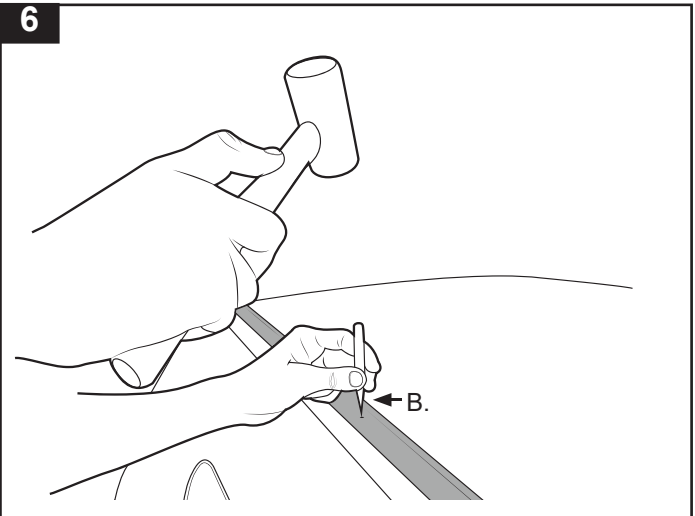
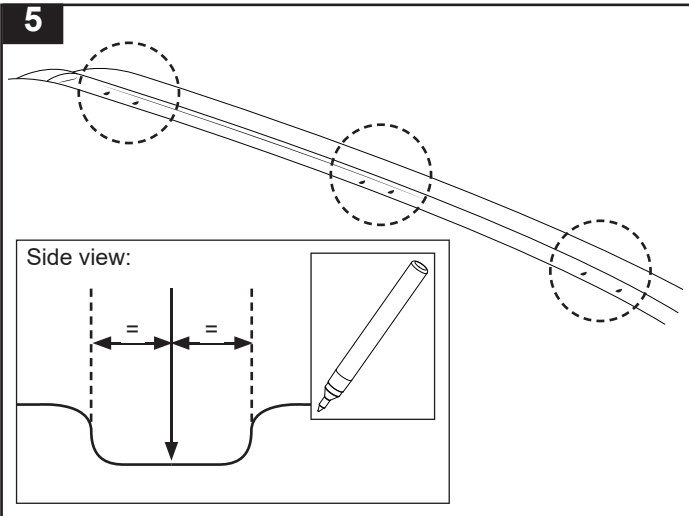
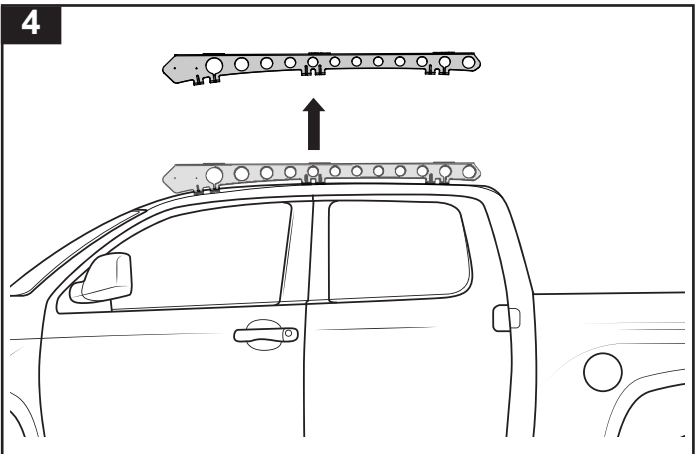
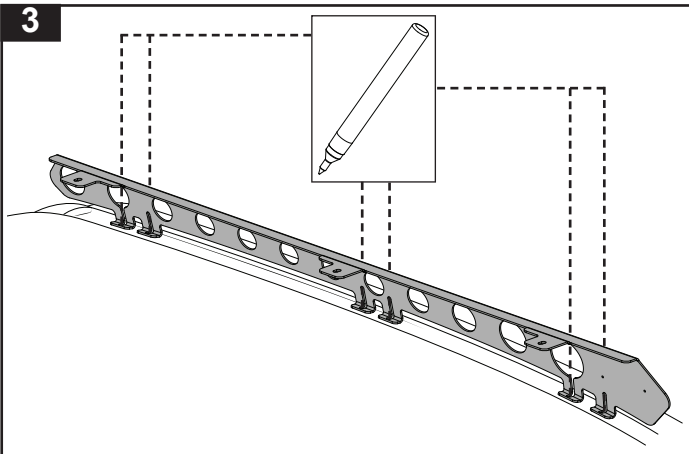

Toyota Tundra Double Cab Backbone - RTTB3

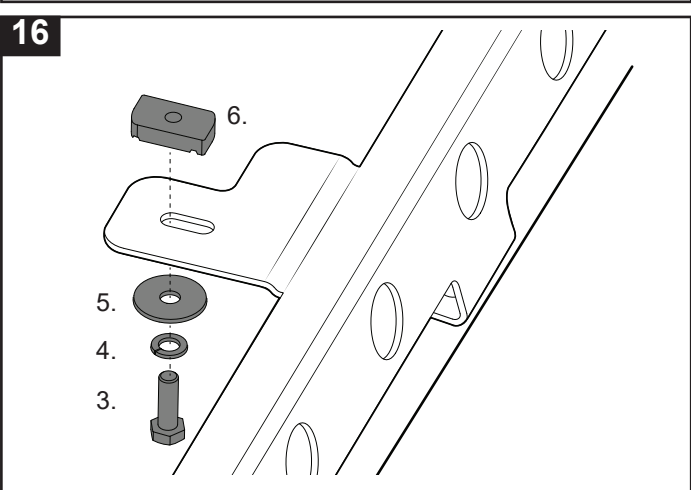
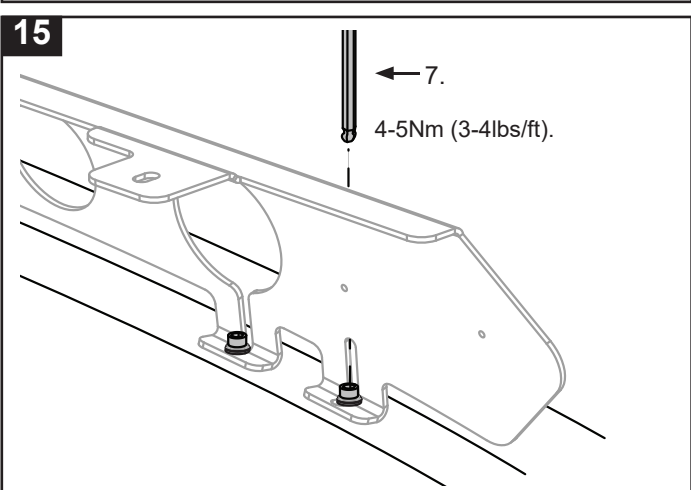
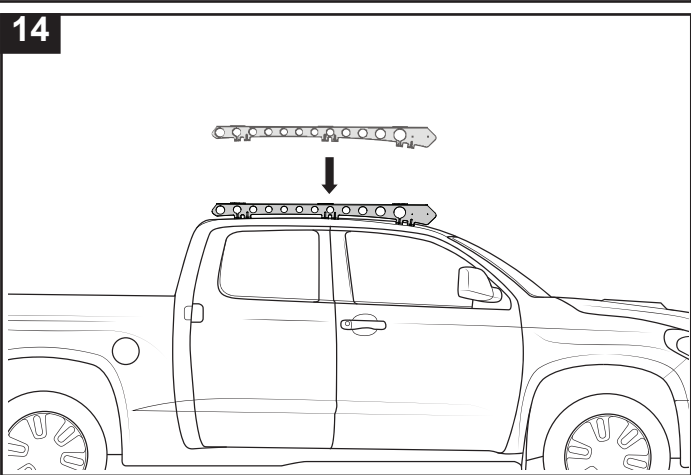
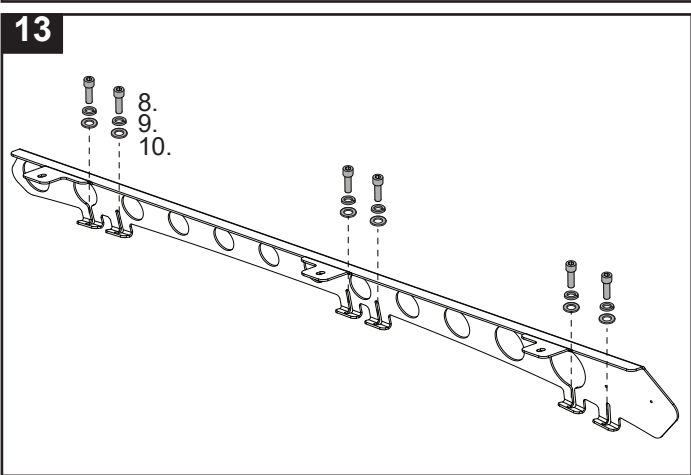
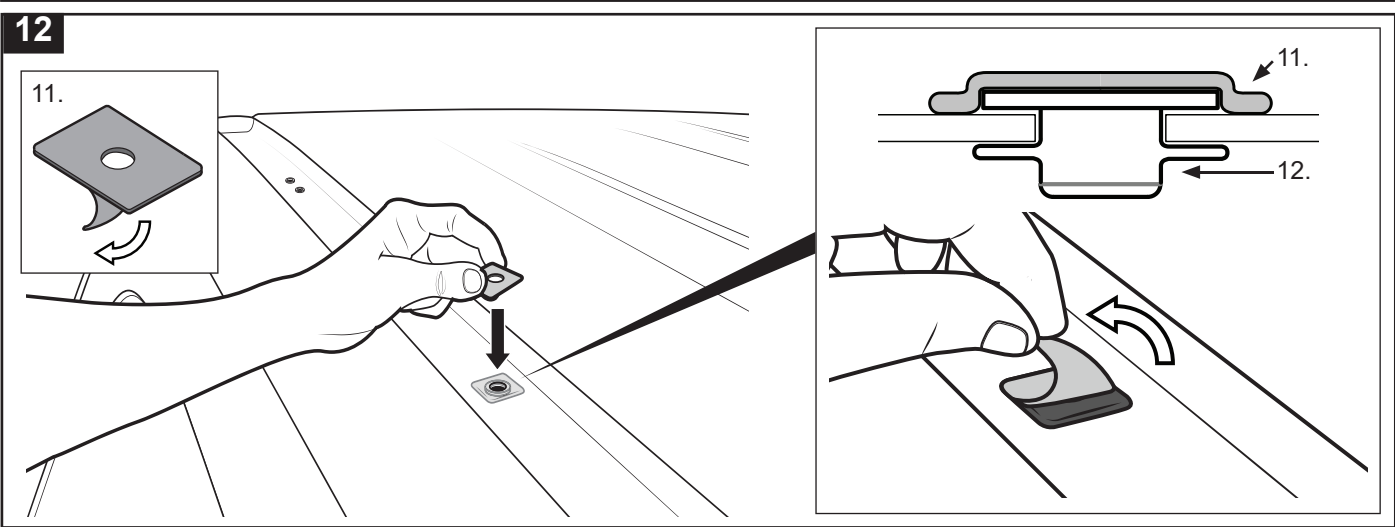
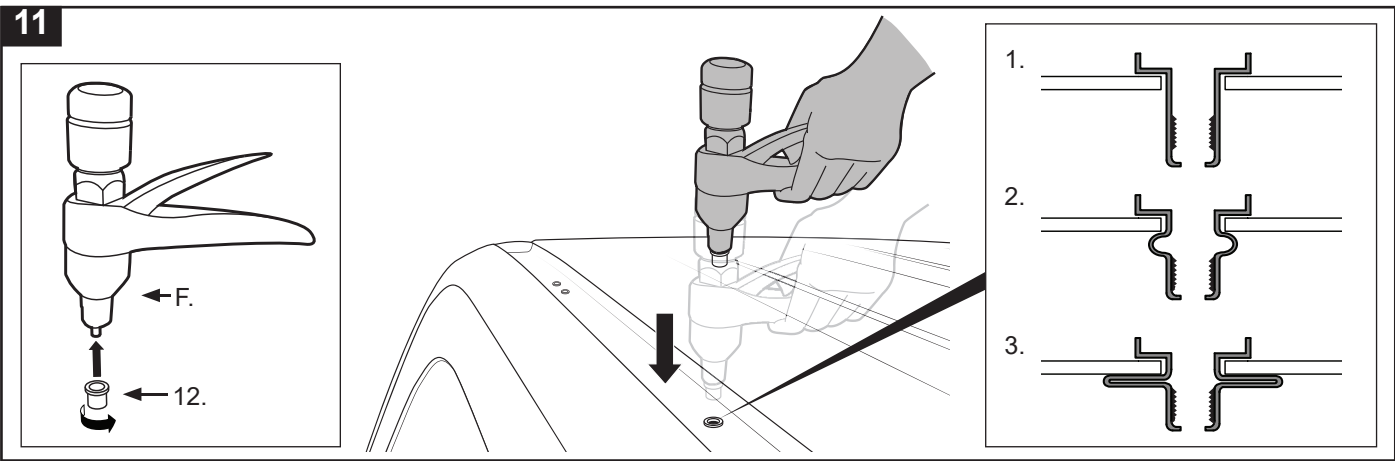

Toyota Tundra Double Cab Backbone - RTTB3

