



RHINO-RACK

Rhino-Rack Rocky Mount Bike Carrier Fat Wheel Adaptor Kit (RBCA033)

Parts List

Item	Component Name	Qty	Part No.
1	Fat Bike Wheel Chock	1	CA1493
2	Wheel Strap Extension	2	CA1494
3	Instructions	1	R475

Note:

RBCA033 Fat Bike Adaptor designed for use with RBC050 Rhino Rocky Mount Bike Carrier.

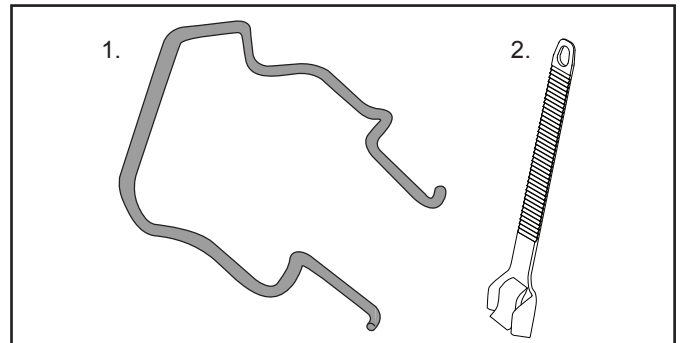

Instructions

1 Remove the Cover Plate on the Arm Assembly.

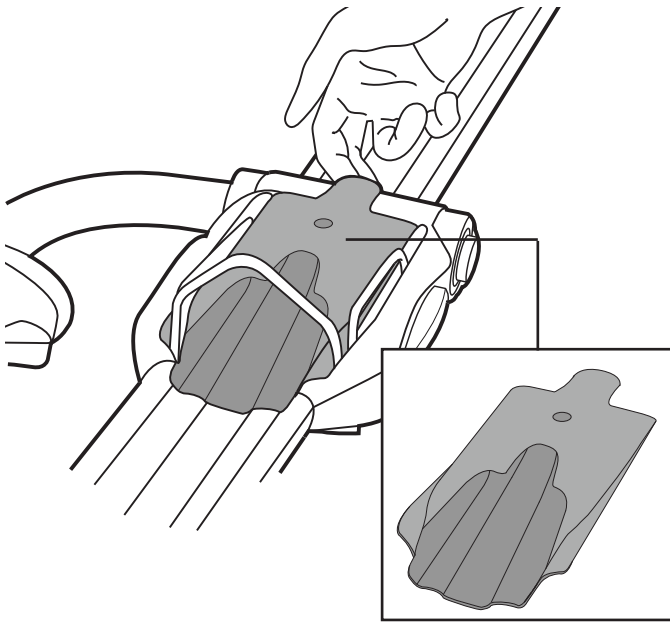

2 Lift the Wheel Chock up partially.

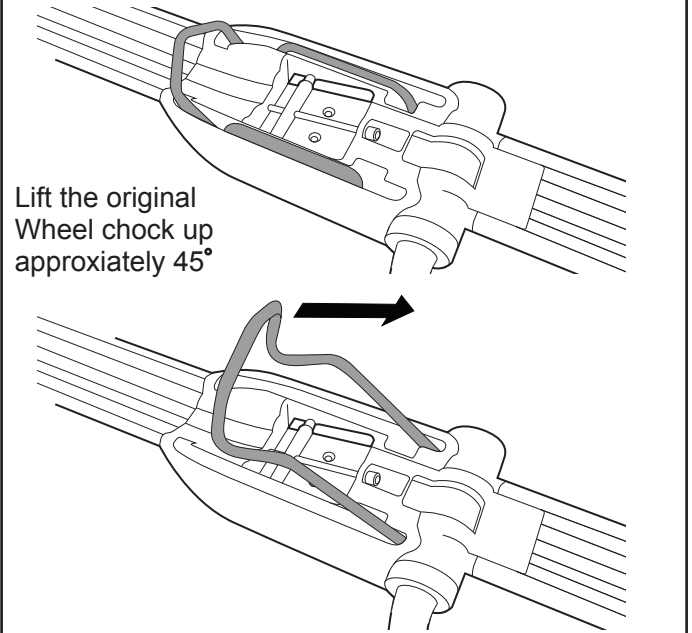

3 1: Compress both sides of the Wheel Chock inwards. 2: This with release it from the Carrier. Remove the Chock.

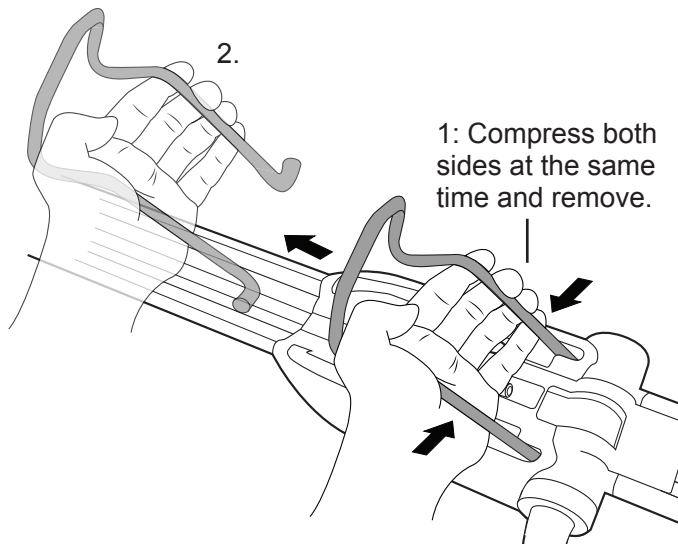

4 Compress both sides of the Fat Wheel Chock inwards. Slide it into the same orientation and position as the original Chock.

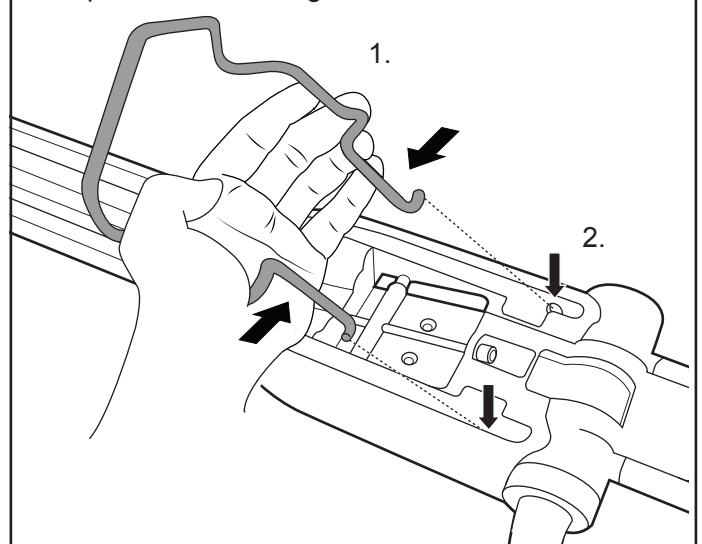



Rhino-Rack Rocky Mount Bike Carrier Fat Wheel Adaptor Kit (RBCA033)

- 5** Replace the Cover Plate onto the Carrier.

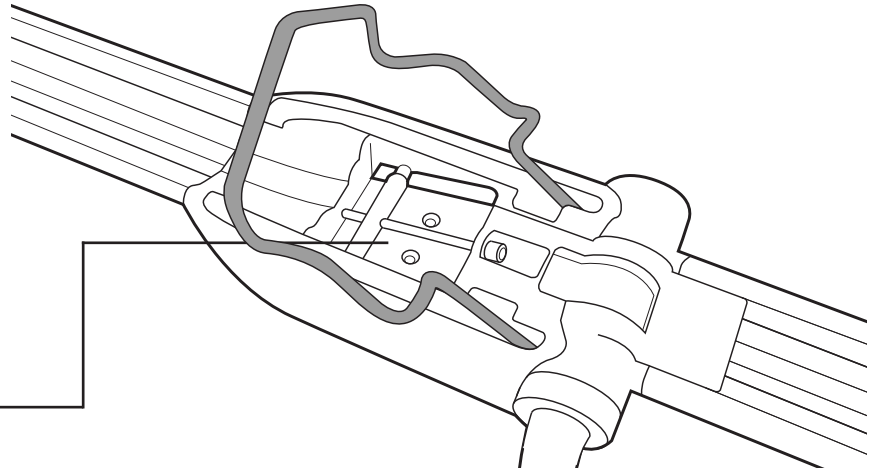
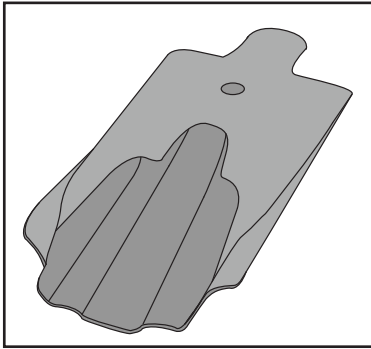

- 6** 1: Slide the Wheel Strap Extension over the Wheel straps already fixed to the Carrier.

2: Secure the Extended Wheel Straps both front and rear of the Bike. Be sure both fittings are secure.

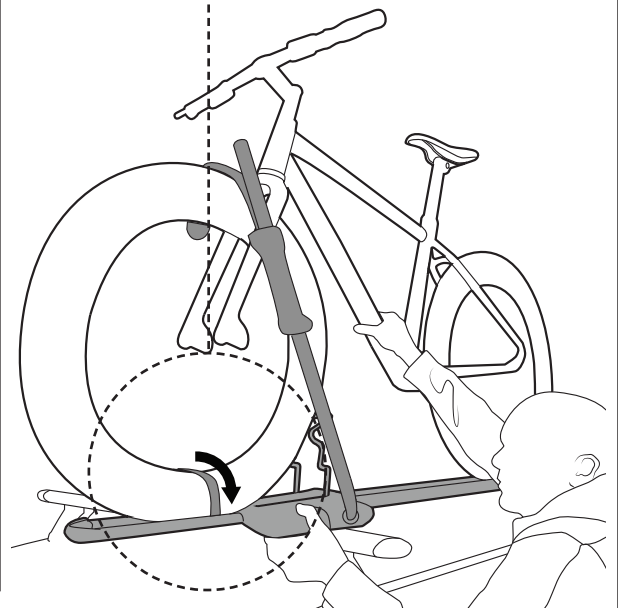
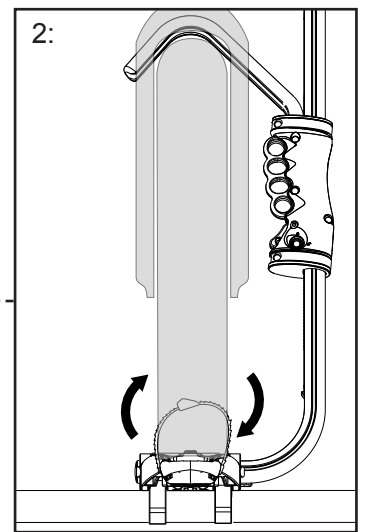
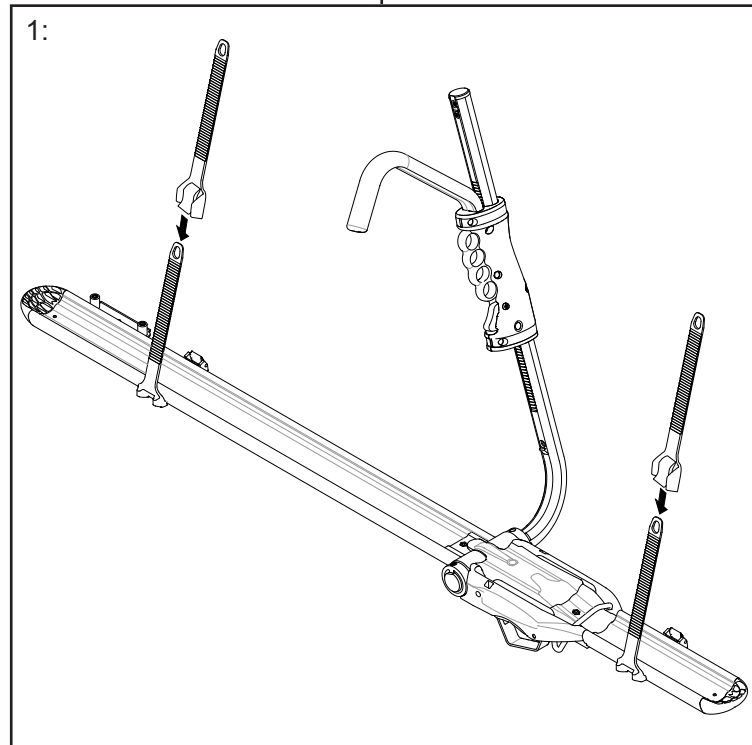

Rhino-Rack
3 Pike Street, Rydalmere,
NSW 2116, Australia.
(Ph) (02) 9638 4744
(Fax) (02) 9638 4822

Document No: R777
Prepared By: Kayle Everett
Authorised By: Chris Murty

Issue No: 01
Issue Date: 20/07/2015

These instructions remain the property of Rhino-Rack Australia Pty Ltd and may not be used or changed for any other purpose than intended.